

THE STATE OF DELAWARE



DEPARTMENT OF TRANSPORTATION
MAINTENANCE AND OPERATIONS
CONSTRUCTION PLANS AND SPECIFICATIONS FOR

COMMUNITY TRANSPORTATION FUND, NORTH V, 2019

CONTRACT NUMBER - T201903105.01

PRIMAVERA ID - 19-03105

FEDERAL AID NUMBER - NONE

COUNTY: NEW CASTLE

PLANS PREPARED BY

[Handwritten signature]
DESIGNER

UNOFFICIAL
WEBSITE
COPY

[Handwritten signature]

DELDOT - CE IV/PROJECT MANAGER
MAINTENANCE AND OPERATIONS - (CAD)

4/4/19

DATE

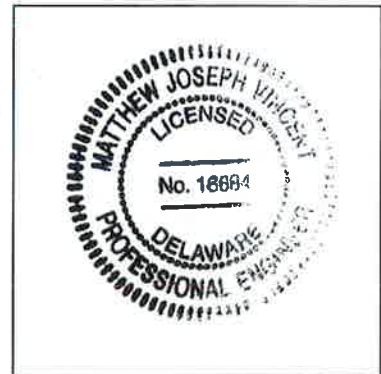

THIS SEAL APPLIES TO ALL SHEETS
BEARING THE "CAD" SECTION
DESIGNATION

APPROVED FOR ADVERTISEMENT

[Handwritten signature]

DIRECTOR OF MAINTENANCE AND OPERATIONS
(Acting)

4/4/19

DATE

DEPARTMENT OF TRANSPORTATION

CONTRACT NUMBER- T201903105.01

(CAD) PAGE 3 OF 56

CONTRACT IS FOR VARIOUS LOCATIONS THROUGHOUT NEW CASTLE COUNTY

LOCATION MAP

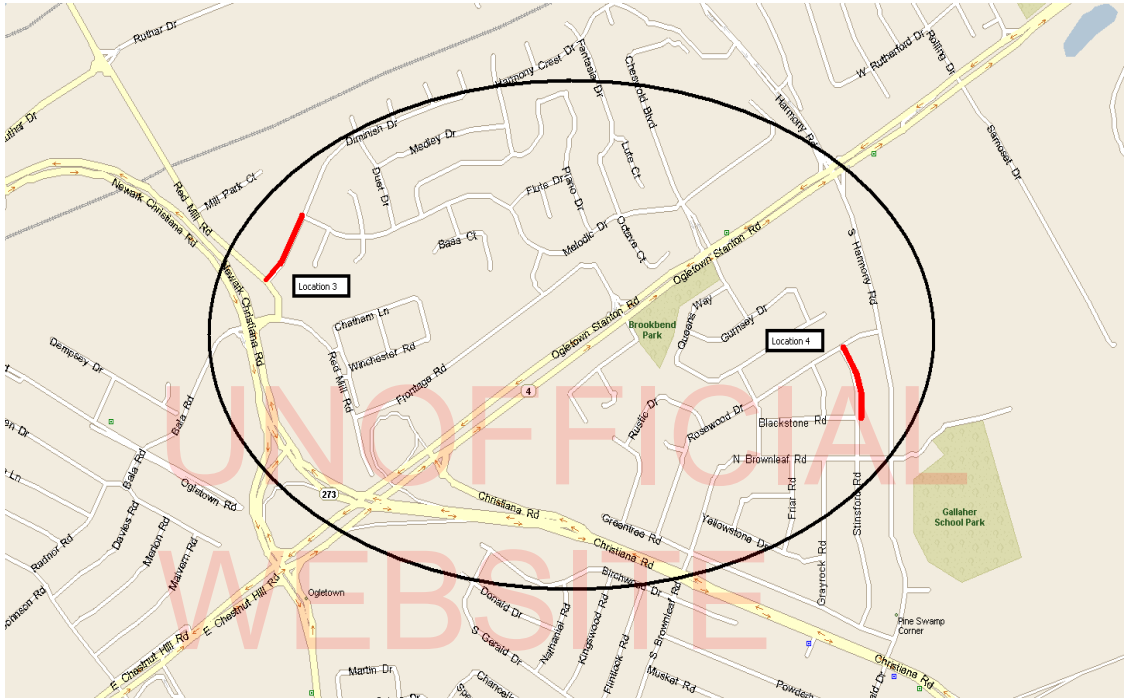

COPY

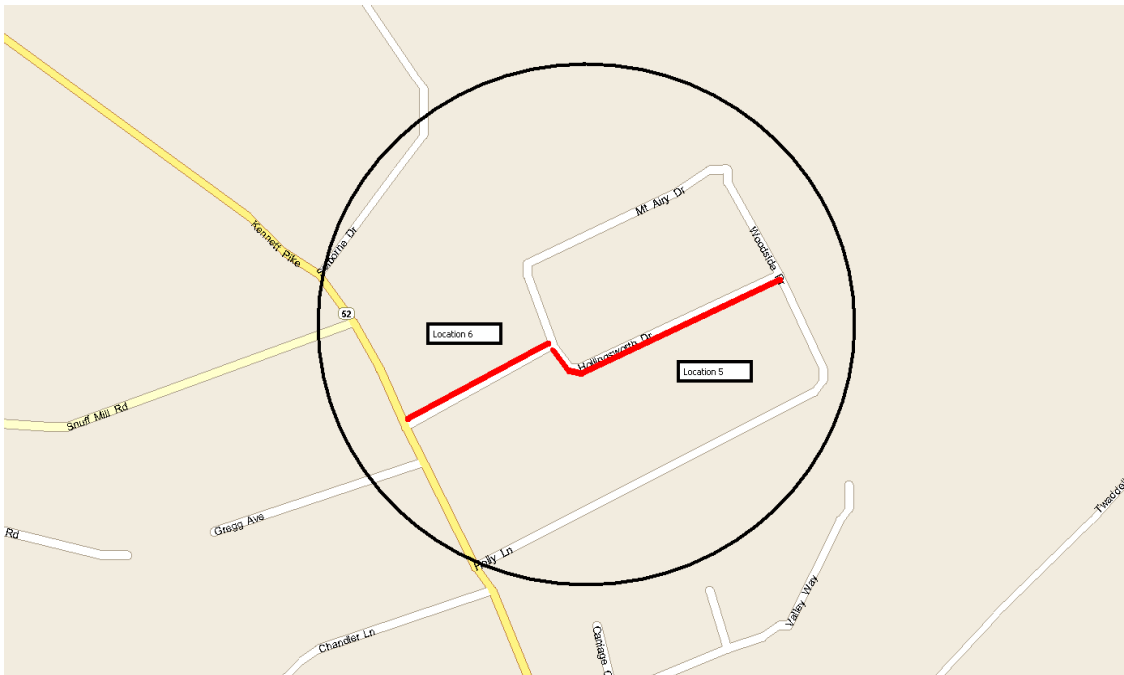

DEPARTMENT OF TRANSPORTATION

CONTRACT NUMBER- T201903105.01

(CAD) PAGE 4 OF 56

CONTRACT IS FOR VARIOUS LOCATIONS THROUGHOUT NEW CASTLE COUNTY

LOCATION MAP

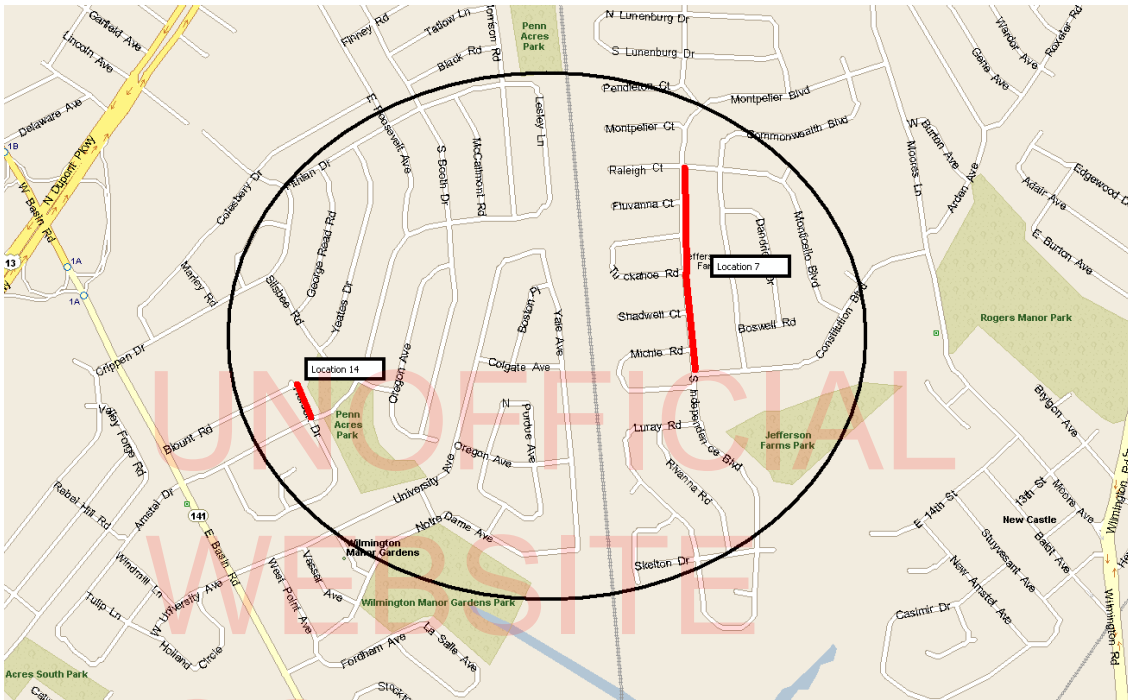

COPY

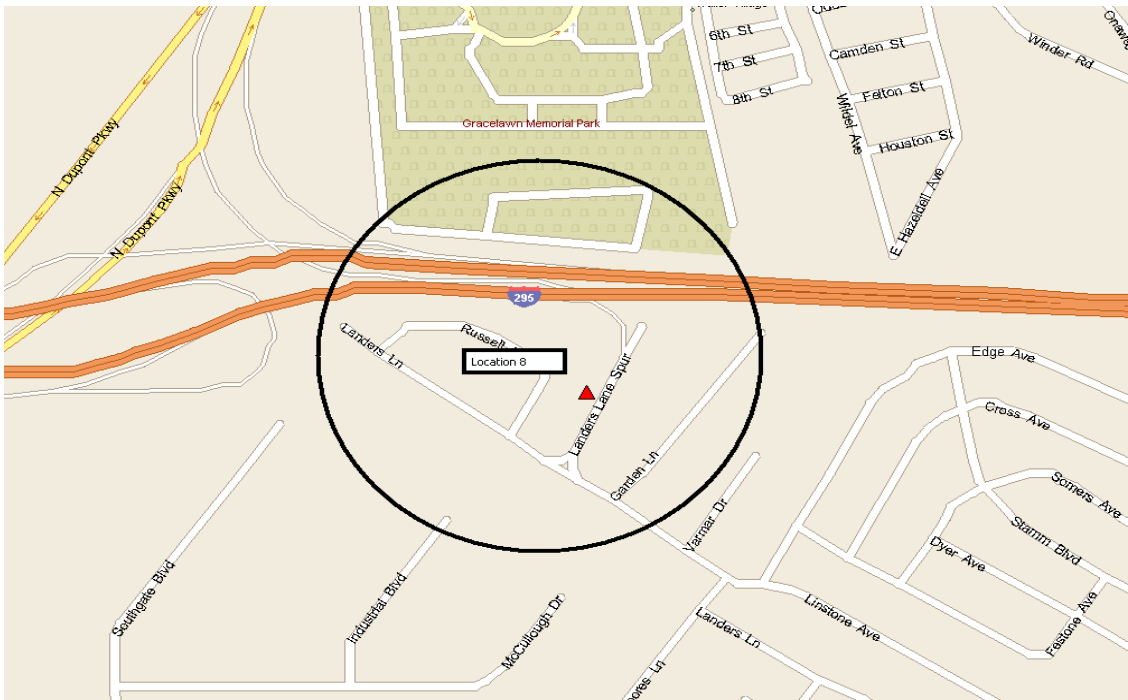

DEPARTMENT OF TRANSPORTATION

CONTRACT NUMBER- T201903105.01

(CAD) PAGE 5 OF 56

CONTRACT IS FOR VARIOUS LOCATIONS THROUGHOUT NEW CASTLE COUNTY

LOCATION MAP

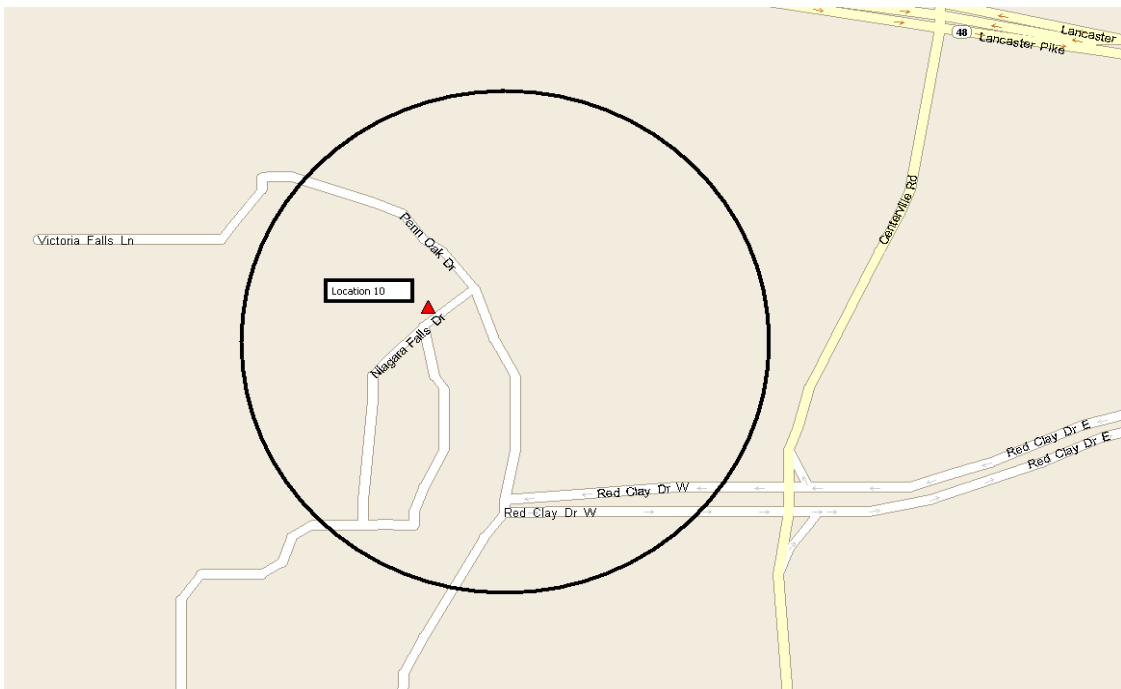
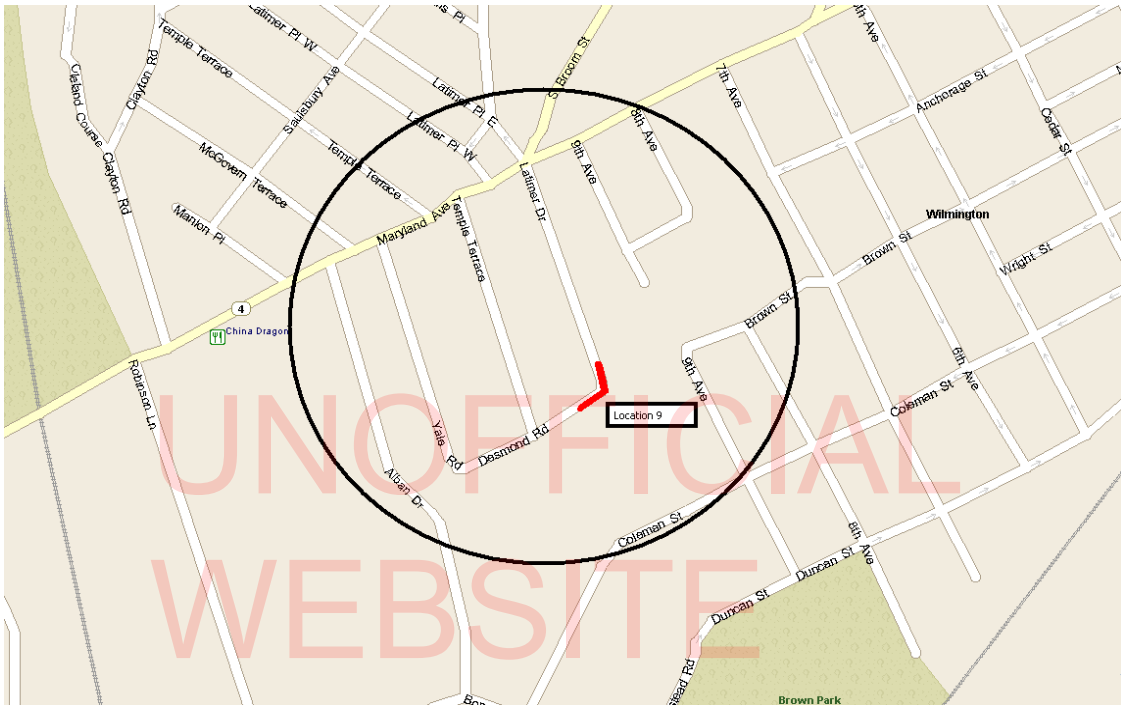

DEPARTMENT OF TRANSPORTATION

CONTRACT NUMBER- T201903105.01

(CAD) PAGE 6 OF 56

CONTRACT IS FOR VARIOUS LOCATIONS THROUGHOUT NEW CASTLE COUNTY

LOCATION MAP

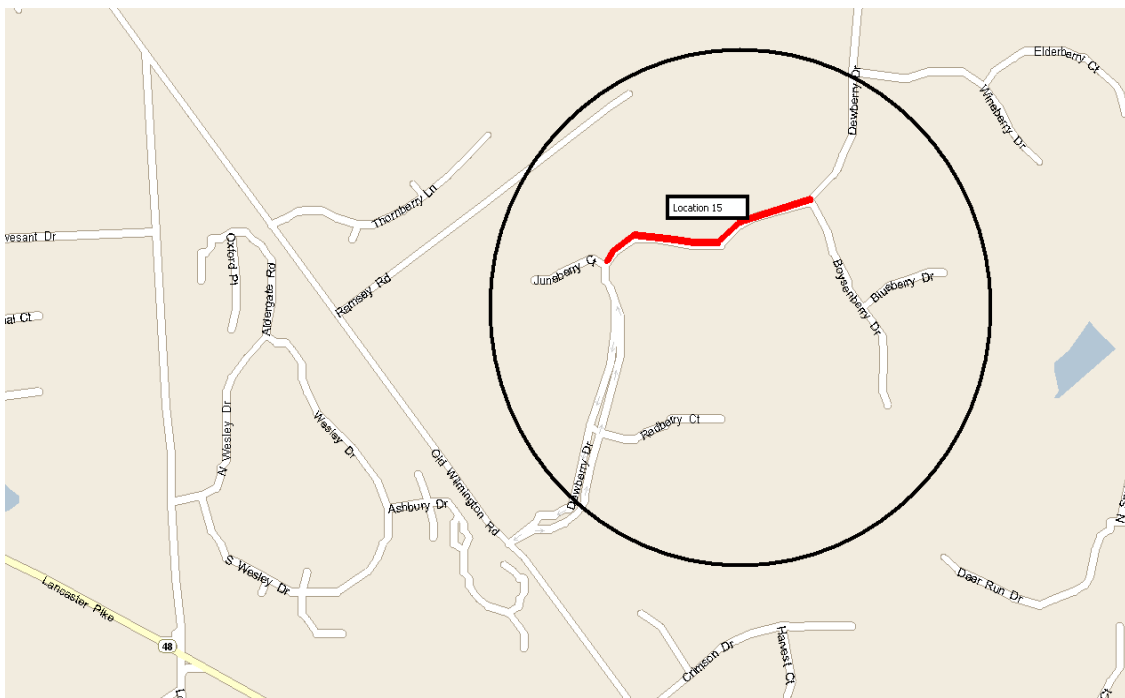
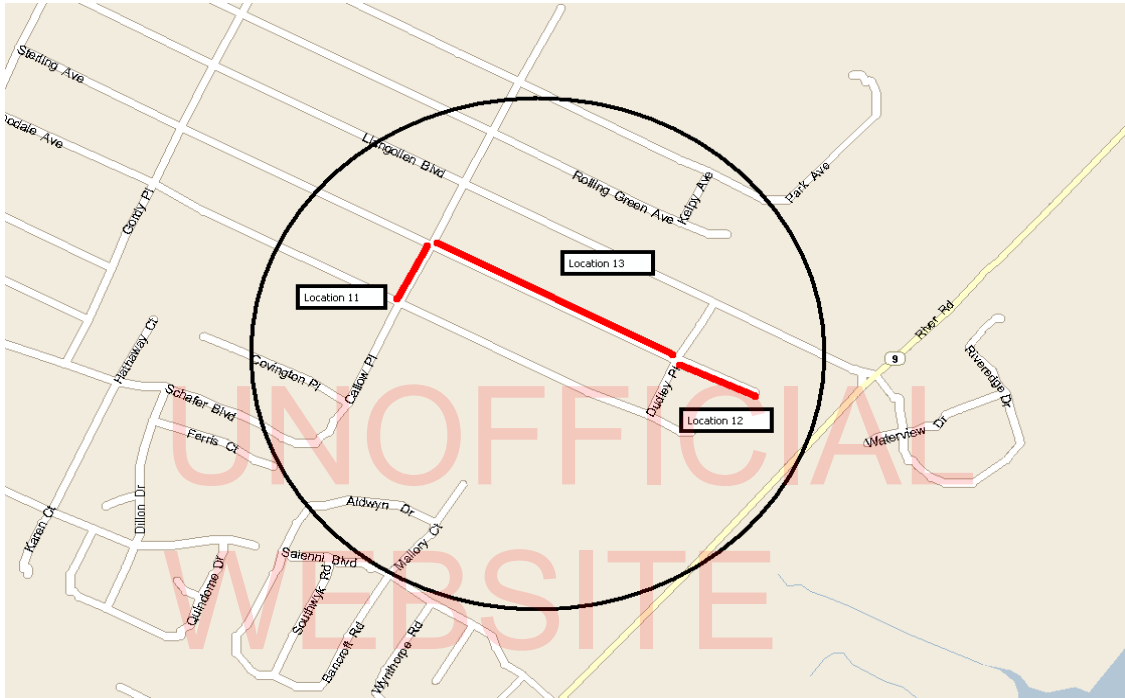

DEPARTMENT OF TRANSPORTATION

CONTRACT NUMBER- T201903105.01

(CAD) PAGE 7 OF 56

CONTRACT IS FOR VARIOUS LOCATIONS THROUGHOUT NEW CASTLE COUNTY

LOCATION MAP

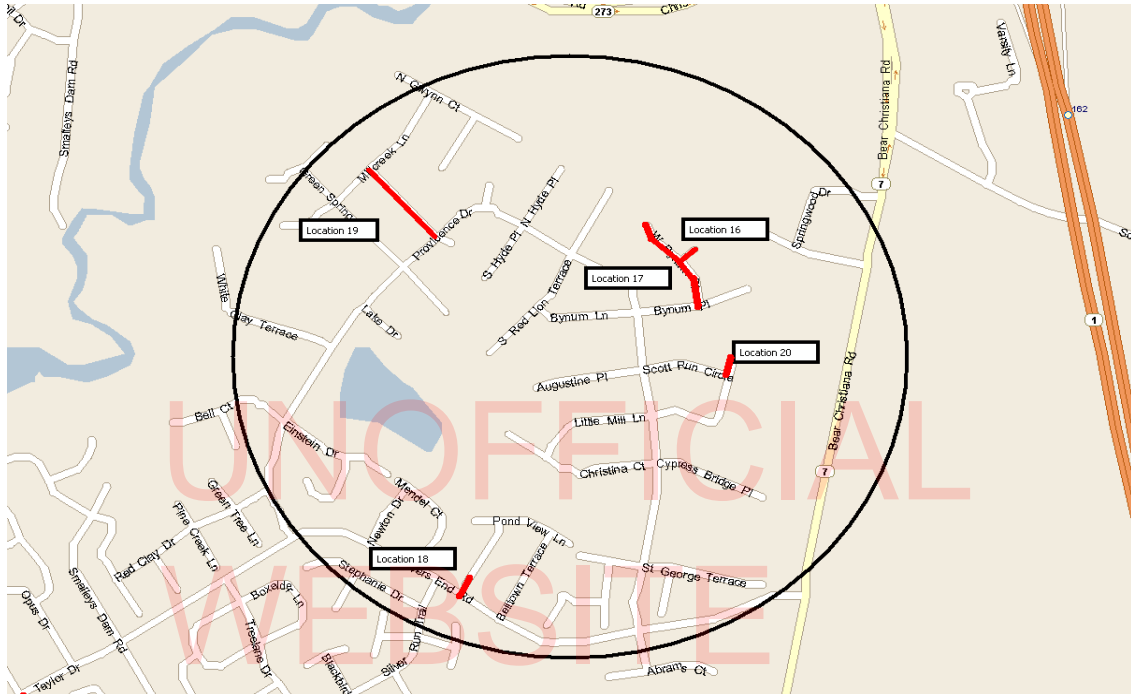

COPY

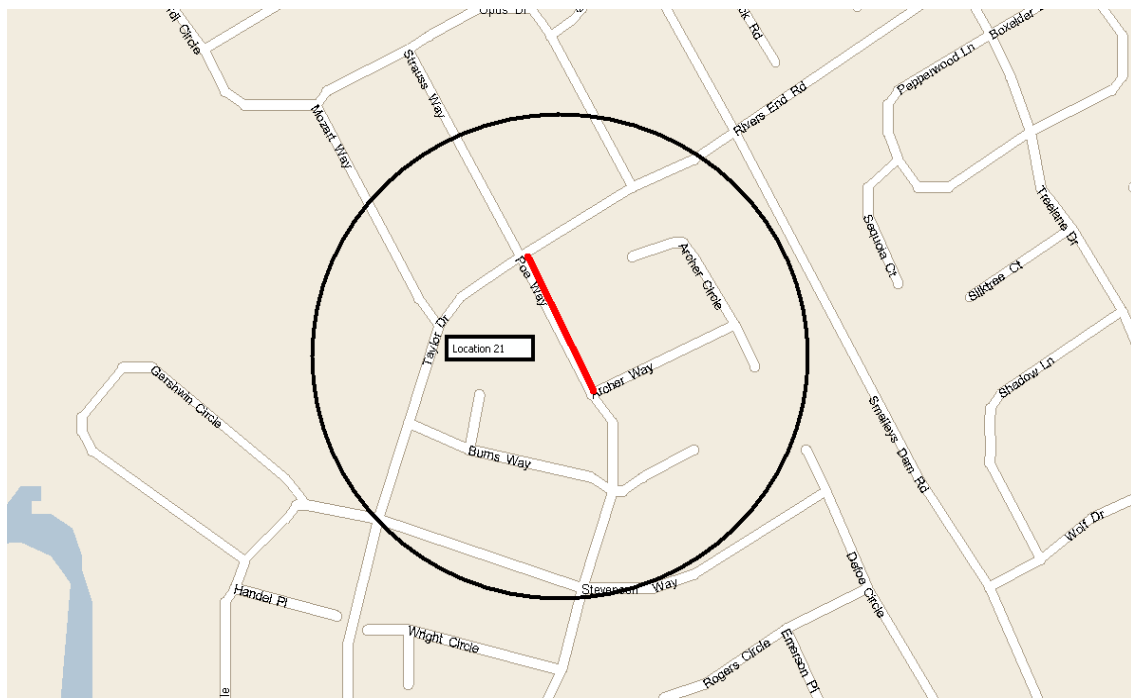

GENERAL CONTRACT PLAN NOTES

SECTION 100

1. THIS PROJECT IS TO BE CONSTRUCTED IN ACCORDANCE WITH THE DELAWARE DEPARTMENT OF TRANSPORTATION STANDARD SPECIFICATIONS FOR ROAD AND BRIDGE CONSTRUCTION DATED AUGUST 2016 AND THE DELAWARE DEPARTMENT OF TRANSPORTATION STANDARD CONSTRUCTION DETAILS, DATED 2016 INCLUDING ALL REVISIONS UP TO THE DATE OF ADVERTISEMENT.

2. THE PURPOSE OF THIS CONTRACT IS TO MAKE GENERAL IMPROVEMENTS TO ROADS AND/OR STREETS WITHIN THE DISTRICT HEREIN SPECIFIED. DEPENDING ON FUND AVAILABILITY, THE DEPARTMENT RESERVES THE RIGHT TO ADD OR DELETE LOCATIONS AND/OR QUANTITIES FOR THIS CONTRACT. SUCH ADDITIONS OR DELETIONS SHALL NOT BE CAUSE FOR AN INCREASE OR DECREASE IN ANY CONTRACT UNIT BID PRICES. NO ITEM PRICES ARE TO BE RENEGOTIATED DUE TO EITHER AN INCREASE OR DECREASE IN QUANTITY USAGE RESULTING FROM SAID ADDITIONS OR DELETIONS.

3. LOCATION LISTINGS INDICATE GENERAL LIMITS OF CONSTRUCTION, MAJOR TYPES OF IMPROVEMENTS, AND ESTIMATED QUANTITIES. DURING THE BIDDING PERIOD, ANY QUESTIONS PERTAINING TO LOCATIONS SHALL BE DIRECTED TO THE CONTRACT ADMINISTRATOR. AFTER THE AWARD, SUCH QUESTIONS SHALL BE REFERRED TO THE APPROPRIATE DISTRICT ENGINEER OR HIS REPRESENTATIVE.

4. THIS CONTRACT WILL HAVE CLEAR "START BY" DATE AND TIME ALLOCATED FOR COMPLETION. FAILURE TO COMPLETE THE CONTRACT IN THE SPECIFIED TIME SHALL CONSTITUTE "FAILURE TO PURSUE THE WORK" AND SUBJECTS THE CONTRACTOR TO LIQUIDATED DAMAGES AS OUTLINED IN SUBSECTION 108.08 OF THE STANDARD SPECIFICATIONS.

THE CONTRACTOR SHALL SUBMIT THE REQUIRED COPIES OF A DETAILED PROGRESS SCHEDULE (PSC) AS OUTLINED IN STANDARD SPECIFICATION 108.04 PRIOR TO OR AT THE PRECONSTRUCTION MEETING. DETAILS SHALL INCLUDE A DESCRIPTION OF EACH WORK ACTIVITY, THE PLANNED DAYS OF WORK, MULTIPLE CREWS OR SHIFTS, AND SCHEDULED WORKING HOURS. DURING THE CONTRACT, THE CONTRACTOR SHALL SUBMIT TWO-WEEK (OR AS REQUIRED) "LOOK AHEAD" SCHEDULES TO THE AREA ENGINEER/ MANAGER NO LATER THAN NOON OF EACH THURSDAY.

GENERAL CONTRACT PLAN NOTES

FAILURE TO COMPLY WILL RESULT IN A SUSPENSION OF ALL CONTRACT WORK WITH TIME CHARGES CONTINUING TO BE ASSESSED.

ADDITIONAL WORK:

5. DEPENDING ON FUND AVAILABILITY, THE DEPARTMENT RESERVES THE RIGHT TO INCREASE THE QUANTITIES OF THE ITEMS SPECIFIED IN THIS CONTRACT. SUCH ADDITIONS SHALL NOT BE CAUSE FOR AN INCREASE OR DECREASE IN ANY CONTRACT UNIT BID PRICES.

SECTION 400

6. THE COST OF CLIPPING BACK THE EDGES OF THE ROADWAY, SHOULDERS, AND THE FIRST 3' OF UNPAVED DRIVEWAY ENTRANCES, PICKING UP AND DISPOSING OF WASTE AND EXCESS MATERIAL, AND CLEANING THE EXISTING PAVEMENT PRIOR TO AN OVERLAY SHALL BE INCIDENTAL TO SECTION 401(.). PREPARING UNPAVED DRIVEWAY ENTRANCES BEYOND THE FIRST 3' SHALL BE PAID UNDER THE APPROPRIATE CONTRACT ITEMS: 202000 AND/OR 30100X. UNLESS SPECIFIED, OVERLAY WIDTHS SHALL MATCH EXISTING WIDTHS.

7. PAVING IS TO BE COMPLETED CURB TO CURB INCLUDING TURN LANES AND INTERSECTIONS WITHIN SEVEN (7) CALENDER DAYS OF PAVEMENT MILLING FOR A PARTICULAR DAYS PAVEMENT MILLING LOCATION. THIS RESTRICTION APPLIES TO EACH DAYS PAVEMENT MILLING OPERATION, NOT AN ENTIRE PROJECT LOCATION. FAILURE TO COMPLY WILL RESULT IN A SUSPENSION OF ALL OTHER CONTRACT WORK WITH TIME CHARGES CONTINUING TO BE ASSESSED.

8. IN ADDITION TO ITEM 401506 SPEED HUMP BEING UTILIZED FOR NEW SPEED HUMPS, IT SHALL ALSO INCLUDE REMOVE AND REPLACE SPEED HUMPS. AT REMOVE AND REPLACE LOCATIONS, 401506 SHALL BE PAID AND THE REMOVAL SHALL BE INCIDENTAL TO THIS ITEM.

GENERAL CONTRACT PLAN NOTES

9. ON THIS CONTRACT, PAVING WILL INCLUDE INTERSECTING STREETS FROM P.C. TO P.C.: MILLING AND PAVING OF INTERSECTING STREETS WILL NOT BE CONSIDERED FOR ENTRANCE, DRIVEWAY AND INTERSECTING STREET PAVEMENT SURCHARGE, NOR WILL DRIVEWAYS AND ENTRANCES WITHIN RIGHT-OF-WAY.

SECTION 500

10. ITEM 501001 PCC PAVEMENT, 8" IS DESIGNATED FOR NOW-DEFUNCT ITEM 701004 PCC VALLEY GUTTER-8". WHEN REPLACING VALLEY GUTTERS, PLEASE REFER TO CONTRACT PLAN DETAILS. DOWEL BARS, WIRE MESH REINFORCEMENT, BITUMINOUS SEAL, AND EXPANSION, PCC SAWCUTS, AND GABC UNDER THE PCC ARE INCIDENTAL TO VALLEY GUTTER ITEM (501001).

SECTION 600

11. DRAINAGE INLET GRATES ADJACENT TO THE ROAD, WITHIN THE PROJECT LIMITS, WHICH ARE NOT TYPE 1 SHALL BE REPLACED. THE ACTUAL LOCATIONS, THE NEED FOR ANY GRATE MODIFICATIONS OR FOR NEW FRAMES SHALL BE DETERMINED BY THE ENGINEER. ALL REPLACED GRATES/ FRAMES SHALL BE DELIVERED TO THE NEAREST DISTRICT MAINTENANCE YARD WITH THE COST OF DELIVERY INCIDENTAL TO 602100/602101 REPLACING DRAINAGE INLETS GRATES/FRAMES. FINAL PAYMENT FOR REPLACED GRATES/ FRAMES SHALL NOT BE MADE UNTIL RECEIPT OF DELIVERED MATERIALS IS PRODUCED, SIGNED BY A DELDOT MAINTENANCE YARD SUPERVISOR.

SECTION 700

12. BUTT JOINTS SHALL BE CONSTRUCTED AT ALL INTERSECTING BITUMINOUS CONCRETE ROADS AND ANY OTHER LOCATIONS AS DIRECTED BY THE ENGINEER. BUTT JOINTS AT RAILROAD

GENERAL CONTRACT PLAN NOTES

CROSSINGS AND AT BRIDGE OR DRAINAGE STRUCTURES NOT TO BE RESURFACED SHALL BE AS PER THE INCLUDED PLAN DETAIL. BUTT JOINTS CUT PRIOR TO THE DAY OF PAVEMENT OVERLAY SHALL BE RAMPED WITH BITUMINOUS CONCRETE TRM INCIDENTAL TO THE ITEM 762004 BUTT JOINT. ONLY BITUMINOUS CONCRETE WILL BE ALLOWED FOR THIS PURPOSE. BUTT JOINTS IN FULL MILL AREAS SHALL BE INCIDENTAL TO THE PAVEMENT MILLING ITEM (760010). SAWCUTS FOR BUTT JOINTS SHALL BE INCIDENTAL TO THE BUTT JOINT ITEM. ALL BITUMINOUS CONCRETE TRM SHALL BE REMOVED PRIOR TO THE PAVING OPERATION.

13. MILLED MATERIAL, SHALL BECOME THE PROPERTY OF THE CONTRACTOR.

14. AFTER PAVEMENT MILLING, ALL RAISED EDGES OF MANHOLES, DRAINAGE INLETS, WATER VALVE BOXES, ETC. SHALL BE RAMPED WITH BITUMINOUS CONCRETE TRM AT A 20:1 OR FLATTER SLOPE INCIDENTAL TO PAVEMENT MILLING. PAVEMENT MILLINGS OR COLD PATCH MATERIAL WILL NOT BE ALLOWED FOR THIS PURPOSE. ALL ADJUSTMENTS SHALL BE MADE NOT MORE THAN SEVEN (7) CALENDAR DAYS PRIOR TO THE PLACEMENT OF THE FINAL COURSE OF BITUMINOUS CONCRETE, UNLESS DIRECTED BY THE ENGINEER. FAILURE TO COMPLY WILL RESULT IN A SUSPENSION OF ALL OTHER CONTRACT WORK WITH TIME CHARGES CONTINUING TO BE ASSESSED. ALL BITUMINOUS CONCRETE TRM SHALL BE REMOVED PRIOR TO THE PAVING OPERATIONS. IF THE CONTRACTOR ELECTS TO ADJUST MANHOLES, DRAINAGE INLETS AND WATER VALVES AFTER THE FINAL COURSE OF PAVING, THIS WORK MUST BE COMPLETED WITHIN SEVEN (7) CALENDAR DAYS OF THE FINAL COURSE OF BITUMINOUS CONCRETE. FAILURE TO COMPLY WILL RESULT IN A SUSPENSION OF ALL OTHER CONTRACT WORK WITH TIME CHARGES CONTINUING TO BE ASSESSED

15. THE CONTRACTOR SHALL TAKE CARE IN REMOVING PAVEMENT AROUND UTILITIES, BUTT JOINTS, CURB EDGES, ETC., WHEN CLEANING AFTER A PAVEMENT MILLING OPERATION. CARE SHOULD BE TAKEN SO AS NOT TO GOUGE OR DIG DEEPER THAN THE REQUIRED DEPTH. FAILURE TO DO SO WILL RESULT IN THE CONTRACTOR PLACING LEVELING COURSES AT HIS OWN EXPENSE.

16. ON THIS CONTRACT FULL MILL AREAS WILL UTILIZE ITEM 760010 PAVEMENT MILLING, BITUMINOUS CONCRETE PAVEMENT (SY-IN). UNLESS OTHERWISE NOTED, ALL MILLING LOCATIONS ARE EXPECTED TO BE MILLED AT A 2" DEPTH. FOR AVERAGE MILLING DEPTHS OF 0.5" TO AN AVERAGE MILLING DEPTH OF 2.25", THE FULL MILL AREAS WILL BE PAID AT AN AVERAGE 2".

GENERAL CONTRACT PLAN NOTES

17. EXCAVATION FOR THE REPLACEMENT OF P.C.C. CURBS, SIDEWALK OR VALLEY GUTTER SHALL BE INCIDENTAL TO THE PRICE BID FOR THESE RESPECTIVE ITEMS. EXCAVATED MATERIAL, NOT NEEDED ON THE PROJECT, SHALL BECOME THE PROPERTY OF THE CONTRACTOR AND REMOVED FROM THE PROJECT. IN THE CASE OF NEW SIDEWALK EXCAVATION WILL BE PAID TO THE WIDTH OF THE NEW SIDEWALK UNDER ITEM 202000. ITEM 908001, TOPSOIL, SHALL BE USED AS BACKFILL MATERIAL FOR CURB AND SIDEWALK WHEN SO DIRECTED BY THE ENGINEER. WHEN REPLACEMENT OF CURB AND GUTTER HAS BEEN COMPLETED AND THE FORMS REMOVED AT EACH LOCATION OF THIS CONTRACT, BACKFILLING SHALL BE DONE IMMEDIATELY. COMPLETE RESTORATION, TOPSOIL, SEEDING, AND REMOVAL OF ALL MATERIALS FOR CURB & GUTTER OR SIDEWALK; SEALING OF VALLEY GUTTERS AND PARGING OF DRAINAGE INLETS, SHALL BE COMPLETED WITHIN SEVEN (7) CALENDER DAYS. FAILURE TO COMPLY WILL RESULT IN A SUSPENSION OF ALL OTHER CONTRACT WORK WITH TIME CHARGES CONTINUING TO BE ASSESSED. TOPSOIL SHALL BE SCREENED/SIFTED SO AS NO MATERIAL GREATER THAN .5" SHOULD BE PRESENT IN MATERIAL USED FOR BACKFILL.

18. AS DIRECTED BY THE ENGINEER, THE CONTRACTOR SHALL PARTIALLY SAW AND FILL WITH AN APPROVED SEALER EXISTING CRACKED CURB AND/OR SIDEWALK. THIS WORK WILL BE INCIDENTAL TO ITEM #762001 SAWCUT - CONCRETE FULL DEPTH.

19. PERTAINING TO PCC CURB REMOVAL & PATCHING, SAWCUTTING IS TO BE PERFORMED PRIOR TO THE REMOVAL OF BITUMINOUS CONCRETE UNLESS APPROVAL IS GIVEN BY THE ENGINEERS REPRESENTATIVE.

20. THE CONTRACTOR SHALL PROVIDE RESIDENTS WITH 24 HR. PRIOR WRITTEN NOTICE FOR ALL PHASES OF CONTRACT WORK INCLUDING BUT NOT LIMITED TO: SAWCUTTING FOR P.C.C. OPERATIONS, P.C.C. REMOVAL AND REPLACEMENT, PAVEMENT MILLING, AND PAVING. THIS NOTICE SHALL BE GIVEN TO ALL RESIDENTS WHOSE PROPERTY IS ADJACENT TO THE STREET ON WHICH WORK IS TO BE PERFORMED. FAILURE TO GIVE PROPER NOTICE WILL RESULT IN A SUSPENSION OF WORK REQUIRING NOTICE, UNTIL PROPER NOTICE IS PROVIDED.

21. BEFORE THE START OF A DAY'S PAVEMENT MILLING OR PAVING OPERATIONS AND WHERE THERE IS EXISTING STRIPING, THE CONTRACTOR SHALL BE REQUIRED TO PROVIDE PROOF THAT ENOUGH

GENERAL CONTRACT PLAN NOTES

MATERIAL OF AN APPROVED ALTERNATIVE STRIPING METHOD IS ON HAND AT THE SITE TO ENSURE STRIPING IS COMPLETE BEFORE TRAFFIC IS RETURNED TO THE ROADWAY.

22. LANE CLOSURES ON NUMBERED MAINTENANCE ROADS ARE PERMITTED ONLY BETWEEN THE HOURS OF 9:00 AM AND 3:00 PM.

23. ITEM 710370 STEEL CASING PIPE-4" IS DESIGNATED FOR NOW-DEFUNCT ITEM 718000 ROOF DRAIN. WHEN REPLACING OR EXTENDING ROOF DRAINS, SUMP PUMP DRAINS, ETC. FROM RIGHT-OF-WAY TO CURBLINE, ITEM 710370 WILL BE UTILIZED REGARDLESS OF PIPE MATERIAL OR SIZE.

SECTION 800

24. AT EACH LOCATION, THE CONTRACTOR SHALL NOTE ALL EXISTING PAVEMENT MARKINGS AND SUBMIT A DRAWING WHICH DEPICTS THE STRIPING PATTERN TO THE DEPARTMENT PRIOR TO THE START OF ANY WORK AT THE LOCATION.

THE CONTRACTOR WILL BE RESPONSIBLE TO CORRECT ANY ERRONEOUS MARKINGS IMMEDIATELY. FAILURE TO COMPLY WILL RESULT IN SUSPENSION OF ALL OTHER CONTRACT WORK WITH TIME CHARGES CONTINUING TO BE ASSESSED. FINAL PAVEMENT MARKINGS SHALL CONFORM TO ALL EXISTING PATTERNS AND SHALL BE PLACED WITHIN FIVE (5) CALENDER DAYS (MAXIMUM) AFTER PLACEMENT OF THE FINAL COURSE OF BITUMINOUS CONCRETE. IF THE CONTRACTOR FAILS TO DOCUMENT THE EXISTING PAVEMENT MARKINGS IN AN ACCEPTABLE MANNER, HE SHALL BE REQUIRED TO PROVIDE AT HIS OWN EXPENSE, A NEW PAVEMENT MARKING PLAN SIGNED AND SEALED BY A PROFESSIONAL ENGINEER REGISTERED IN THE STATE OF DELAWARE.

AT THE END OF EACH DAY'S OPERATION AND BEFORE TRAFFIC IS RETURNED TO UNRESTRICTED ROADWAY USE, TEMPORARY MARKINGS SHALL BE UTILIZED AT LOCATIONS THAT REQUIRE PERMANENT MARKING.

GENERAL CONTRACT PLAN NOTES

TEMPORARY PAVEMENT STRIPING MUST MATCH PERMANENT PAVEMENT STRIPING IN ALL REGARDS.

TEMPORARY PAVEMENT MARKINGS SHALL BE PAID AT THE APPLICABLE CONTRACT UNIT PRICE. THE CONTRACTOR IS RESPONSIBLE FOR MAINTAINING THE TEMPORARY MARKINGS IN GOOD CONDITION SUCH THAT THE PAVEMENT IS PROPERLY DELINEATED AT ALL TIMES. ANY REFRESHING OF THE TEMPORARY MARKINGS WILL BE AT THE CONTRACTOR'S EXPENSE.

PLACEMENT OF TEMPORARY MARKINGS SHALL RECEIVE PRIOR APPROVAL FROM THE ENGINEER. PAYMENT FOR TEMPORARY PAVEMENT MARKING SHALL BE MADE AT THE UNIT PRICE BID FOR ITEM 817003 - TEMPORARY MARKINGS.

25. THE CONTRACTOR, WITH THE ENGINEER, SHALL INVENTORY ALL SIGNS ON ALL ROADS SUBJECT TO IMPROVEMENTS. NECESSARY SIGNS SHALL BE MAINTAINED IN OPERATION DURING CONSTRUCTION AND ANY OTHER SIGNS SHALL BE PROPERLY STORED WITH THE CONTRACTOR, WHO SHALL BE RESPONSIBLE FOR LOSS OR DAMAGE. IMMEDIATELY PRIOR TO FINAL INSPECTION, THE CONTRACTOR AND ENGINEER SHALL AGAIN INVENTORY THE TRAFFIC SIGNS AND ACCOUNT FOR ANY LOST OR DAMAGED SIGNS. LOST OR DAMAGED SIGNS, AT THE DISCRETION OF THE ENGINEER SHALL BE REPLACED IN KIND AT THE CONTRACTOR'S EXPENSE.

26. BEFORE WORK IS DONE AT ANY LOCATION, THE APPROPRIATE DISTRICT SAFETY OFFICER MUST APPROVE THE MOT FOR THAT LOCATION TWO WEEKS IN ADVANCE. ANY ANTICIPATED IMPACT TO TRAFFIC SIGNALS MUST BE REVIEWED BY THE DELDOT TRAFFIC SECTION PRIOR TO CONSTRUCTION. THEY CAN BE CONTACTED AT 302-659-2400.

27. ANY ERRONEOUS MARKING WILL NOT BE PAID FOR AND SHALL BE CORRECTED IMMEDIATELY AT THE CONTRACTOR'S EXPENSE. ERRONEOUS MARKINGS OR SHADOWS THAT EXCEED ONE (1) INCH IN WIDTH SHALL BE REMOVED BY EITHER SAND OR WATER BLASTING. NO OTHER REMOVAL METHODS WILL BE ALLOWED.

GENERAL CONTRACT PLAN NOTES

28. THE CONTRACTOR SHALL SUBMIT A TRAFFIC CONTROL PLAN, INCLUDING PEDESTRIAN AND BICYCLE FACILITIES, AS WELL AS THE NECESSARY NCHRP 350 OR THE MANUAL FOR ASSESSING SAFETY HARDWARE (MASH) CERTIFICATIONS FOR ALL DEVICES THAT WILL BE UTILIZED, FOR EACH LOCATION BEFORE THE START OF THE PRE-CONSTRUCTION MEETING. WRITTEN APPROVAL MUST BE RECEIVED BEFORE THE START OF WORK AT EACH AND EVERY LOCATION.

29. ALL TRAFFIC CONTROL DEVICES SHALL BE IN NEW OR REFURBISHED CONDITION AND SHALL BE IN COMPLIANCE WITH THE NCHRP 350 OR THE MANUAL FOR ASSESSING SAFETY HARDWARE (MASH). THE DEVICES SHALL BE APPROVED BY THE SAFETY SECTION PRIOR TO USE AND SHALL BE MAINTAINED IN GOOD CONDITION FOR THE DURATION OF THE CONTRACT.

30. ALL WORK SHALL BE PERFORMED IN A MANNER THAT WILL REASONABLY PROVIDE THE LEAST PRACTICABLE OBSTRUCTION TO ALL ROAD USERS, INCLUDING VEHICULAR, PEDESTRIAN AND BICYCLE TRAFFIC, AND SHALL CONFORM TO THE REQUIREMENTS OF THE 2011 DELAWARE MANUAL ON UNIFORM TRAFFIC CONTROL DEVICES, PART 6, INCLUDING ALL REVISIONS UP TO THE DATE OF ADVERTISEMENT FOR BIDS.

31. PEDESTRIAN MAINTENANCE OF TRAFFIC: THIS WORK SHALL CONSIST OF PROVIDING AND MAINTAINING AN ACCESSIBLE PEDESTRIAN ROUTE THROUGHOUT THE PROJECT'S LIMITS IN ACCORDANCE WITH THE AMERICANS WITH DISABILITIES ACT OF 1990 (ADA) TITLE II, PARAGRAPH 35.130. THE CONTRACTOR SHALL BE REQUIRED TO REVIEW EACH CURB RAMP LOCATION AND SUBMIT THE APPROPRIATE MAINTENANCE OF TRAFFIC DETAIL AND DEVICES TO THE ENGINEER FOR EACH LOCATION AT LEAST 2-WEEKS BEFORE CONSTRUCTION FOR REVIEW, COMMENT, AND APPROVAL. THE FOLLOWING CONSIDERATIONS SHALL BE TAKEN INTO ACCOUNT WHEN ADDRESSING ACCESSIBLE PEDESTRIAN MAINTENANCE OF TRAFFIC:

- ALL PEDESTRIANS, INCLUDING PERSONS WITH DISABILITIES, SHALL BE PROVIDED WITH A REASONABLY SAFE, CONVENIENT AND ACCESSIBLE PATH THAT REPLICATES AS MUCH AS PRACTICABLE THE EXISTING PEDESTRIAN FACILITIES.
- MAINTAIN ACCESS TO ALL BUSINESS AND RESIDENTS AT ALL TIMES.
- PROVIDE PEDESTRIAN ACCESS THRU OR AROUND THE WORK ZONE. IF A DETOUR IS CHOSEN THE CONTRACTOR MUST SUBMIT THE DETOUR ROUTE TO THE ENGINEER FOR REVIEW AND APPROVAL. THE DETOUR ROUTE MUST MEET OR EXCEED THE CURRENT CONDITIONS.

GENERAL CONTRACT PLAN NOTES

- WORK SHOULD BE PHASED SO THAT ALL AREAS OF AN INTERSECTION/SIDEWALK PATH ARE NOT UNDER CONSTRUCTION AT THE SAME TIME UNLESS A CLEAR PATH IS PROVIDED AND IDENTIFIED.

SECTION 900

- 32. EROSION CONTROL MULCH BLANKET SHALL BE USED IN ALL DISTURBED AREAS UNLESS DIRECTED OTHERWISE BY THE ENGINEER.**

CTF/OPEN END SPECIFIC PROJECT NOTES

- 33. NO UTILITY RELOCATION INVOLVEMENT IS ANTICIPATED. SHOULD ANY CONFLICTS BE ENCOUNTERED DURING CONSTRUCTION REQUIRING ADJUSTMENT AND/OR RELOCATION OF THE AGENCIES' EXISTING FACILITIES, THE NECESSARY RELOCATION WORK SHALL BE ACCOMPLISHED BY THE RESPECTIVE AGENCIES' FORCES, AS DIRECTED BY THE DISTRICT ENGINEER. ANY ADJUSTMENTS AND/OR RELOCATIONS OF MUNICIPALLY OWNED FACILITIES SHALL BE DONE BY THE STATE'S CONTRACTOR IN ACCORDANCE WITH THE RESPECTIVE AGENCIES' STANDARD SPECIFICATIONS AS DIRECTED BY THE DISTRICT ENGINEER.**
- 34. NO ENVIRONMENTAL PERMITS ARE REQUIRED FOR THIS WORK PROVIDED NO JURISDICTIONAL WETLANDS OR WATERS ARE IMPACTED. IF THERE IS ANY QUESTION AS TO WHETHER OR NOT A WATER OR WETLAND IS JURISDICTIONAL, CONTACT THE DEL DOT ENVIRONMENTAL SECTION AT 302-760-2264.**
- 35. IT IS ANTICIPATED THAT ALL WORK WILL OCCUR WITHIN DELDOT'S EXISTING RIGHT OF WAY OR EASEMENT AREAS. SHOULD THE NEED OCCUR TO TRESPASS ONTO PRIVATE PROPERTY; IT WILL BE THE RESPONSIBILITY OF THE PROJECT MANAGER TO SECURE SUCH TRESPASS NEEDS.**

GENERAL CONTRACT PLAN NOTES

36. NO WORK NEAR OR WITHIN RAILROAD RIGHT-OF-WAY IS ANTICIPATED. IF ANY RAILROAD PROPERTY OR FACILITIES ARE NEAR OR WITHIN THE PROPOSED LIMITS OF WORK OR IF THE PROPOSED WORK ENCROACHES UPON THE RAILROAD'S RIGHT-OF-WAY, THE CONTRACTOR SHALL BE RESPONSIBLE FOR OBTAINING THE REQUIRED CLEARANCES AND INSURANCES FOR EACH INVOLVED RAILROAD IN ACCORDANCE WITH THE APPROPRIATE DELDOT MAINTENANCE OF RAILROAD TRAFFIC ITEM. DELDOT'S RAILROAD SECTION MANAGER MUST BE CONTACTED AT (302) 760-2183 TO COORDINATE THE EXECUTION OF THE APPROPRIATE AGREEMENTS AND AUTHORIZATIONS REQUIRED FROM ANY RAILROAD COMPANY INVOLVED, INCLUDING COORDINATION FOR RAILROAD FLAGGING, IF NECESSARY.

37. THE PROJECT MANAGER SHALL BE RESPONSIBLE FOR COORDINATING WITH THE TRAFFIC SECTION RELATING TO ANY IMPACTS TO TRAFFIC SECTION FACILITIES (INCLUDING BUT NOT LIMITED TO TRAFFIC LOOPS, JUNCTION WELLS ETC.) AT LEAST 4 WEEKS IN ADVANCE OF THE START OF THE ACTIVITY. PRIOR TO INITIATING ANY WORK ON THIS CONTRACT (OR SITES), THE PROJECT MANAGER SHALL BE RESPONSIBLE FOR PREPARING AND SUBMITTING FOR APPROVAL OF THE SAFETY SECTION, A MAINTENANCE OF TRAFFIC PLAN. SUFFICIENT TIME SHALL BE PROVIDED FOR THE REVIEW AND APPROVAL OF THE PLAN. THE MAINTENANCE OF TRAFFIC PLAN SHALL INCLUDE PROPOSED TIME RESTRICTIONS ON THE CLOSURE OF TRAVEL LANES SUBJECT TO THE APPROVAL OF THE SAFETY SECTION.

38. THE PROJECT MANAGER IS RESPONSIBLE FOR ENSURING ANY REQUIRED DOCUMENTS AND ANALYSIS AS PART OF THE ADOPTED WORK ZONE SAFETY AND MOBILITY PROCEDURES AND GUIDELINES HAS BEEN COMPLETED PRIOR TO ANY WORK STARTING ON THIS CONTRACT.

39. THE DEPARTMENT RESERVES THE RIGHT TO REQUEST AN EXTENSION OF THIS CONTRACT, WITH THE AGREEMENT OF THE CONTRACTOR, AT THE CURRENT CONTRACT PRICES.

40. THE WORK WILL BE SCHEDULED VIA JOB ORDERS FROM THE DISTRICT. WORK SITES WILL VARY IN SIZE. THE JOB ORDERS WILL INDICATE THE WORK TO BE PERFORMED AT EACH LOCATION.

GENERAL CONTRACT PLAN NOTES

41. THIS CONTRACT IS NOT SUBJECT TO DEPARTMENT OF LABOR'S PREVAILING WAGE RATES PER THE DELAWARE CODE, 29 Del. C. § 6960(m).

42. WORK TO BE PERFORMED UNDER THIS CONTRACT SHALL BE GENERATED THROUGH JOB ORDERS ISSUED TO THE CONTRACTOR BY THE DEPARTMENT'S PROJECT MANAGER. JOB ORDERS WILL BE ASSEMBLED TO ALLOW THE MOST EFFICIENT ALLOCATION OF THE CONTRACTOR'S WORK FORCE AS THE SITUATION ALLOWS.

EACH JOB ORDER ISSUED WILL HAVE CLEAR "START BY" DATE AND TIME ALLOCATED TO COMPLETE SAID JOB ORDER. FAILURE TO COMPLETE A JOB ORDER IN THE SPECIFIED TIME SHALL CONSTITUTE "FAILURE TO PURSUE THE WORK" AND SUBJECTS THE CONTRACTOR TO LIQUIDATED DAMAGES AS OUTLINED IN SUBSECTION 108.08 OF THE STANDARD SPECIFICATIONS.

EACH JOB ORDER IS TO BE COMPLETED WITHIN THE SPECIFIED TIME. ADDITIONAL ITEMS AND/OR WORKING DAYS MAY BE ADDED TO ANY JOB ORDER AS NEEDED AT THE DISCRETION OF THE ENGINEER. IF THE WORK ON A SPECIFIED JOB ORDER IS NOT COMPLETED WITHIN THE ALLOCATED TIME, LIQUIDATED DAMAGES WILL BE ASSESSED IN ACCORDANCE WITH SUBSECTION 108.09 OF THE STANDARD SPECIFICATIONS BASED ON THE TOTAL VALUE OF THAT PARTICULAR JOB ORDER.

43. UPON RECEIPT OF EACH JOB ORDER, THE CONTRACTOR SHALL SUBMIT THE REQUIRED COPIES OF A DETAILED PROGRESS SCHEDULE (PSC) AS OUTLINED IN STANDARD SPECIFICATION 108.04. DETAILS SHALL INCLUDE A DESCRIPTION OF EACH WORK ACTIVITY, THE PLANNED DAYS OF WORK, MULTIPLE CREWS OR SHIFTS, AND SCHEDULED WORKING HOURS. DURING THE CONTRACT, THE CONTRACTOR SHALL SUBMIT TWO-WEEK (OR AS REQUIRED) "LOOK AHEAD" SCHEDULES TO THE AREA ENGINEER/MANAGER NO LATER THAN NOON OF EACH THURSDAY. FAILURE TO COMPLY WILL RESULT IN A SUSPENSION OF ALL CONTRACT WORK WITH TIME CHARGES CONTINUING TO BE ASSESSED.

DELAWARE DEPARTMENT OF TRANSPORTATION

CONTRACT NUMBER- T201903105.01

(CAD) PAGE 21 OF 56

CANAL

CONTRACT IS FOR VARIOUS LOCATIONS THROUGHOUT NEW CASTLE COUNTY

DETAILS SHEET

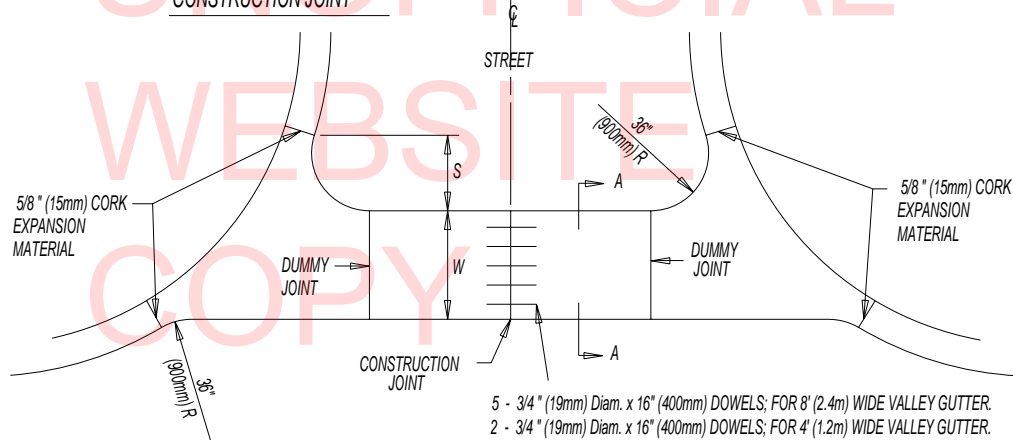
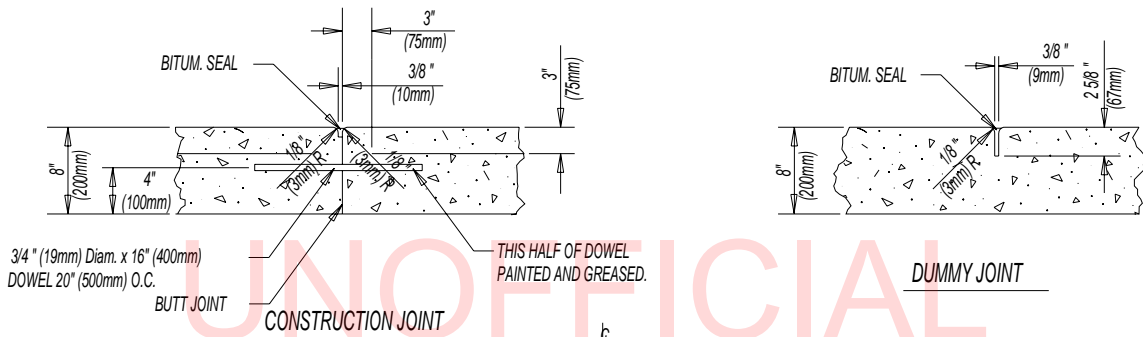

5 - 3/4" (19mm) Diam. x 16" (400mm) DOWELS; FOR 8' (2.4m) WIDE VALLEY GUTTER.
 2 - 3/4" (19mm) Diam. x 16" (400mm) DOWELS; FOR 4' (1.2m) WIDE VALLEY GUTTER.

PLAN

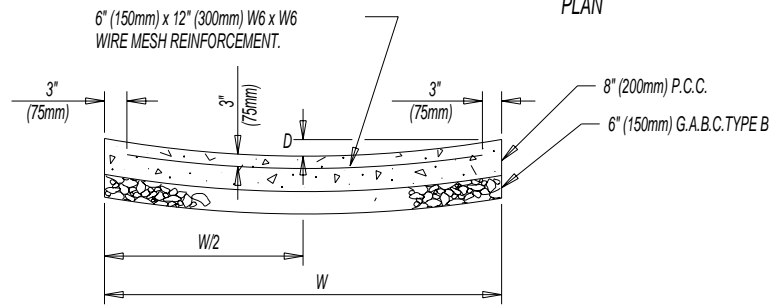

SECTION A-A

P.C.C. VALLEY GUTTER

WIDTH W	DEPTH D	OFFSET S
8' (2.4m)	3" (75mm)	16" (405mm)
4' (1.2m)	1 1/2" (38mm)	23 1/2" (585mm)

DELAWARE DEPARTMENT OF TRANSPORTATION

CONTRACT NUMBER- T201903105.01

(CAD) PAGE 22 OF 56

CANAL

CONTRACT IS FOR VARIOUS LOCATIONS THROUGHOUT NEW CASTLE COUNTY

DETAILS SHEET

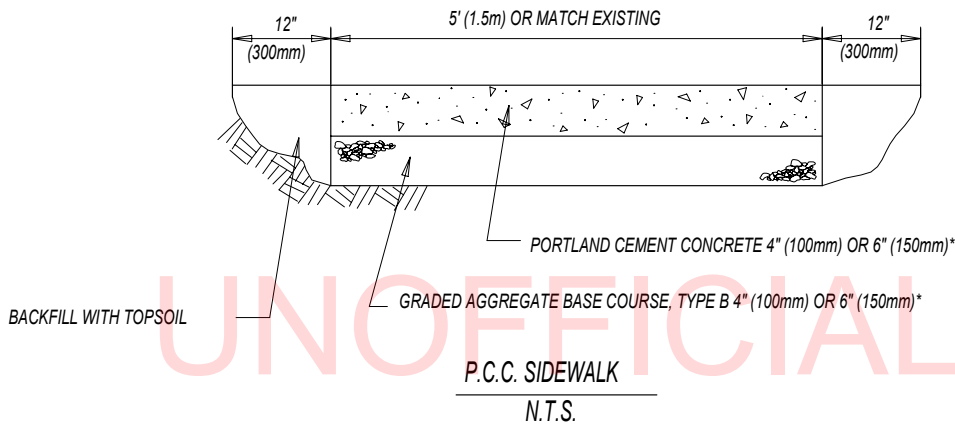

* NOTE: 6" (150mm) CONCRETE OVER 6" (150mm) GRADED AGGREGATE TO BE USED FOR DRIVEWAY PLACEMENT

NOTE: ALL EDGES TO BE SAWCUT. CUTTING BY USE OF AIR HAMMERS MAY BE SUBSTITUTED FOR SAWCUTTING IF THE AREA IS TO BE OVERLAID UNDER THE SAME CONTRACT. THERE WILL BE NO PAYMENT FOR AIR HAMMERS. THIS DETAIL SHALL BE USED FOR ALL BITUMINOUS CONCRETE PATCHES UNLESS OTHERWISE SHOWN ON THE PLANS.

IN AREAS WHERE NO BITUMINOUS CONCRETE OVERLAY IS PROPOSED, PLACE 2" (50mm) BITUMINOUS CONCRETE TYPE C PATCHING OVER 6" (150mm) BCBC BITUMINOUS CONCRETE PATCHING.

FOR BITUMINOUS CONCRETE PATCHING, PARTIAL DEPTH, REMOVE EXISTING BITUMINOUS CONCRETE TO DEPTH OF EXISTING AGGREGATE BASE. REPLACE WITH BITUMINOUS CONCRETE TYPE C PATCHING.

BITUMINOUS CONCRETE PATCH DETAIL

N.T.S.

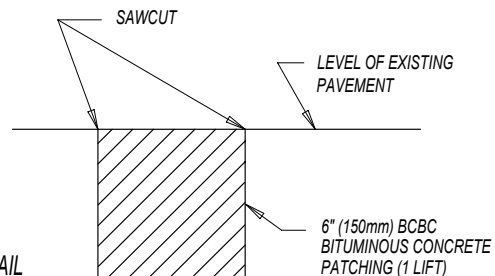

DELAWARE DEPARTMENT OF TRANSPORTATION

CONTRACT NUMBER- T201903105.01

(CAD) PAGE 23 OF 56

CANAL

CONTRACT IS FOR VARIOUS LOCATIONS THROUGHOUT NEW CASTLE COUNTY

DETAILS SHEET

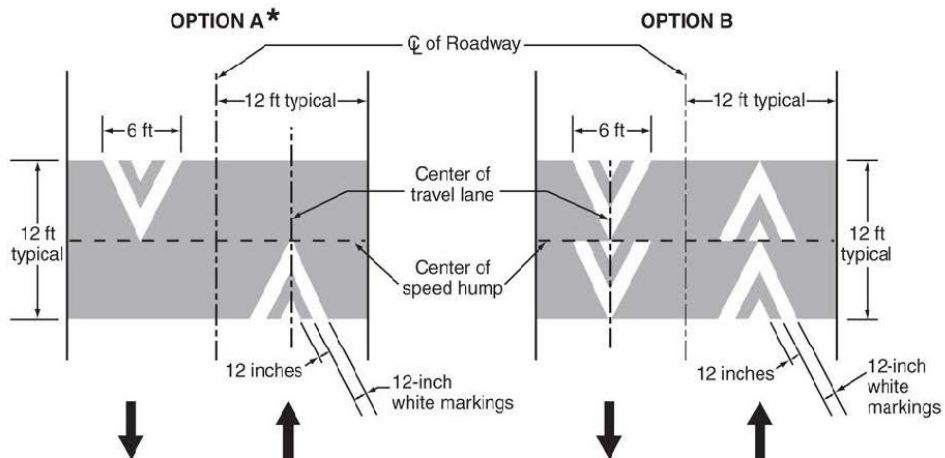
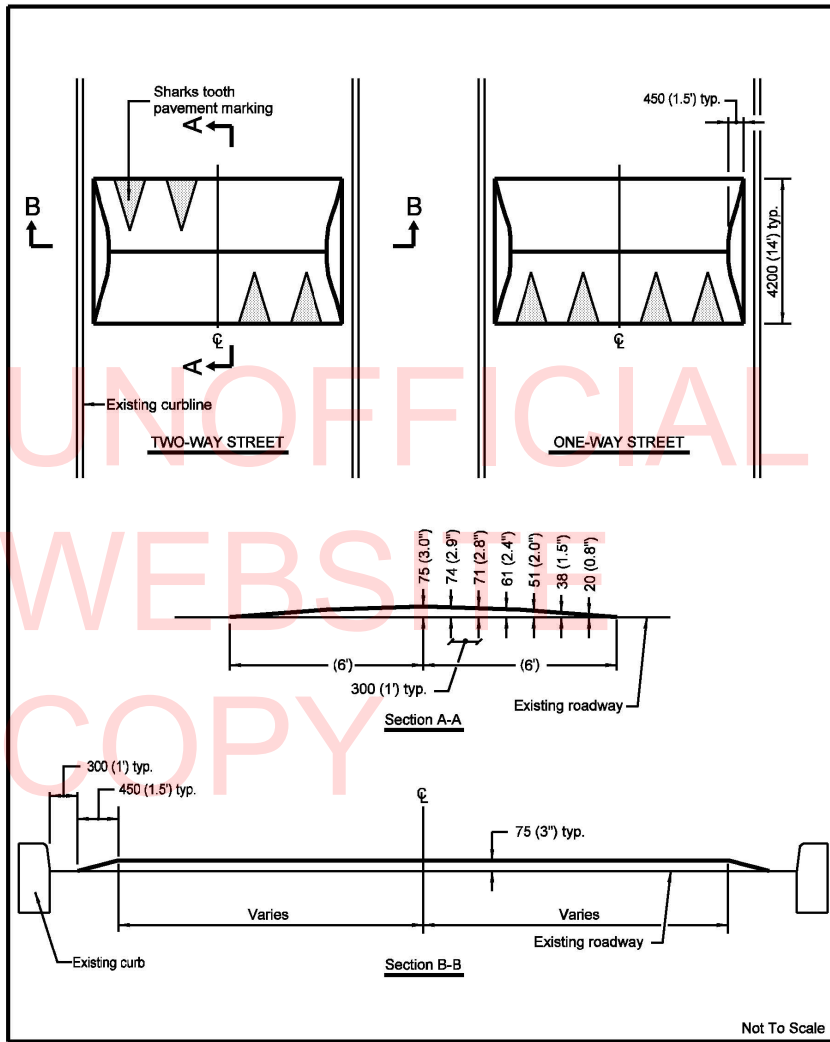

DELAWARE DEPARTMENT OF TRANSPORTATION

CONTRACT NUMBER- T201903105.01

(CAD) PAGE 24 OF 56

CANAL

CONTRACT IS FOR VARIOUS LOCATIONS THROUGHOUT NEW CASTLE COUNTY

DETAILS SHEET

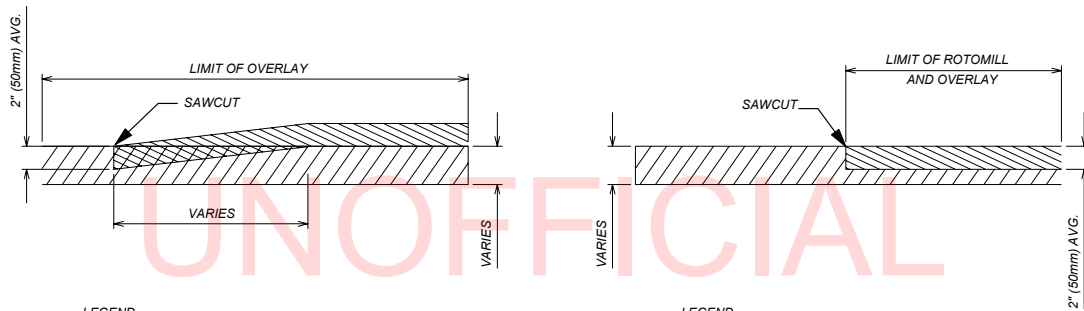

LEGEND

- PROPOSED OVERLAY
- EXISTING PAVEMENT
- EXISTING PAVEMENT TO BE REMOVED

LEGEND

- PROPOSED FULL WIDTH ROTOMILL AND OVERLAY
- EXISTING PAVEMENT (TO REMAIN)

BUTT JOINT
FOR OVERLAY SECTION*
PAYMENT UNDER ITEM 762004

BITUMINOUS CONCRETE JOINT
FOR FULL WIDTH MILL SECTION*
PAYMENT INCIDENTAL TO ITEM 760010, MILLING

BITUMINOUS CONCRETE JOINT DETAIL

NOTE: THE FOLLOWING LENGTHS ARE BASED ON THE POSTED SPEED OF THE ROADWAY: LESS THAN 50MPH = 20 FT PER 1" OF OVERLAY DEPTH
EQUAL TO OR GREATER THAN 50 MPH = 30 FT PER 1" OF OVERLAY DEPTH
AT STOP SIGNS = 15 FT PER 1" OF OVERLAY DEPTH

DELAWARE DEPARTMENT OF TRANSPORTATION

CONTRACT NUMBER- T201903105.01

(CAD) PAGE 25 OF 56

CANAL

CONTRACT IS FOR VARIOUS LOCATIONS THROUGHOUT NEW CASTLE COUNTY

DETAILS SHEET

REMOVE AND DISPOSE OF EXISTING FRAME AND COVER AS DIRECTED BY OWNER IF NOT UTILIZED IN THE ADJUSTMENT.
PLACE NEW OR EXISTING FRAME AND COVER (AS REQUIRED) TO CORRECT ELEVATION, RECOLLAR AND PLACE BITUMINOUS CONCRETE PATCH. NEW FRAME AND COVER (IF REQUIRED) TO BE PROVIDED BY OWNER.

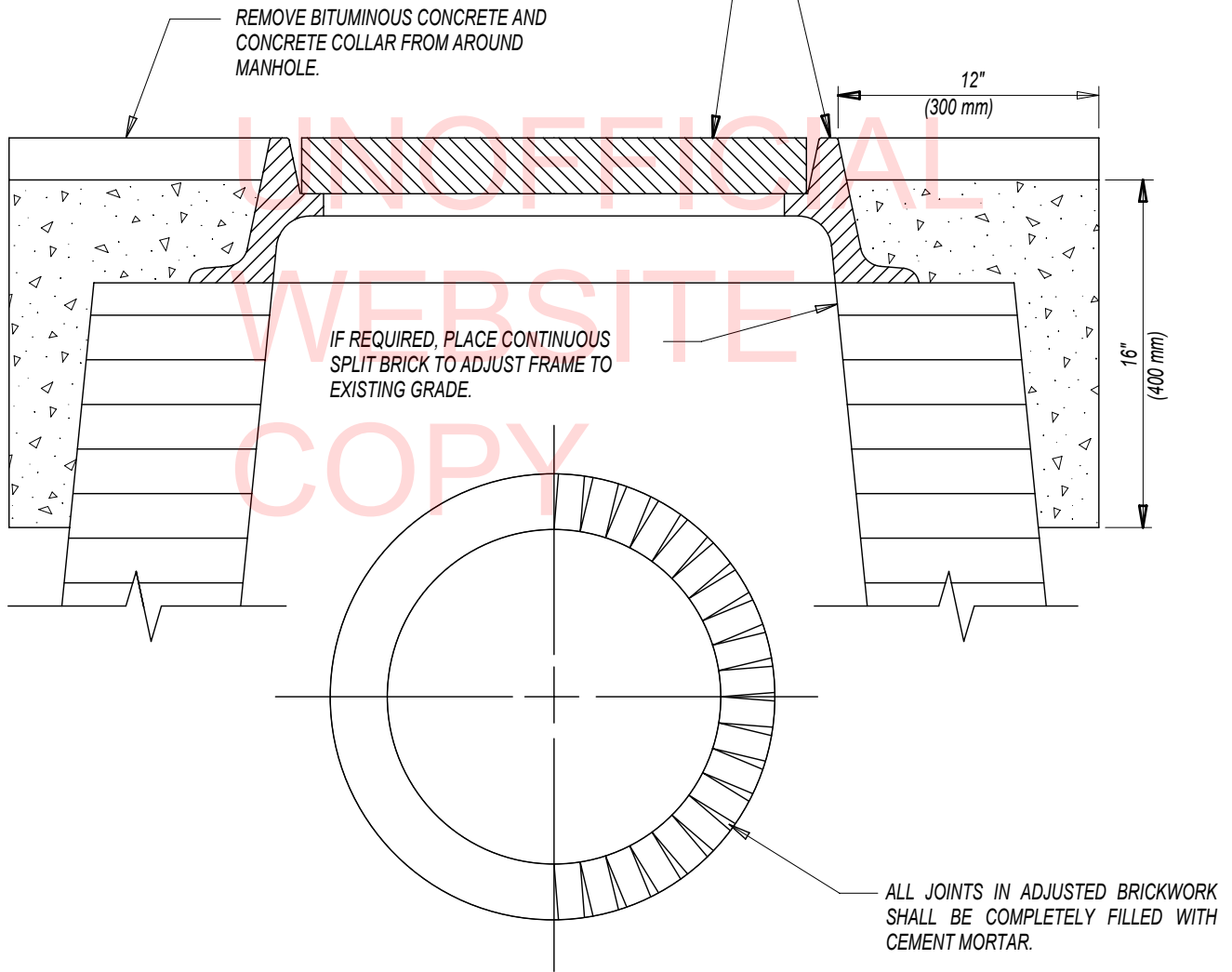

ADJUSTING AND REPAIRING MANHOLE

N.T.S.

NOTE: MANHOLES IN CONCRETE ROADWAYS SHALL BE SAWCUT FULL DEPTH TO THE SPECIFIED DIMENSION PRIOR TO ANY ADJUSTMENT BEING MADE. THE SAWCUTTING SHALL BE INCIDENTAL TO ITEM 602132.

DELAWARE DEPARTMENT OF TRANSPORTATION

CONTRACT T201903105.01

(CAD) PAGE 26 OF 56

CANAL

COMMUNITY TRANSPORTATION FUND, NORTH V, 2019

LOCATION 1 **COUNTRY ACRES - SCHAGRIN DRIVE FROM BUNKER HILL ROAD TO END**
LENGTH 388.6200 m 1275.0000 L.F.
GENERAL IMPROVEMENTS
 2" MILL AND OVERLAY

COMMENTS:

MATERIAL ESTIMATE FOR LOCATION 1

401005	SUPERPAVE TYPE C, PG 64-22 (CARBONATE STONE)	410.00	TON
401030	SUPERPAVE TYPE B, PG 64-22, PATCHING	15.00	TON
402000	BITUMINOUS CONCRETE PATCHING	240.00	SY-IN
760010	PAVEMENT MILLING, BITUMINOUS CONCRETE PAVEMENT	6,560.00	SY-IN
760011	PAVEMENT MILLING, BITUMINOUS CONCRETE PAVEMENT, TAPER CUT	385.00	SY-IN
762000	SAW CUTTING, BITUMINOUS CONCRETE	238.00	L.F.
802003	ARROW PANELS TYPE C	4.00	EA-DY
808001	FURNISH AND MAINTAIN TRUCK MOUNTED ATTENUATOR, TYPE I	4.00	EA-DY
811001	FLAGGER, NEW CASTLE COUNTY STATE	96.00	HOUR
811013	FLAGGER, NEW CASTLE COUNTY, STATE, OVERTIME	10.00	HOUR
817002	PERMANENT PAVEMENT STRIPING, SYMBOL/LEGEND, ALKYD-THERMOPLASTIC	24.00	S.F.
817003	TEMPORARY MARKINGS, PAINT, 4"	24.00	L.F.
817013	PERMANENT PAVEMENT STRIPING, EPOXY RESIN PAINT, WHITE/YELLOW, 5"	24.00	L.F.

DELAWARE DEPARTMENT OF TRANSPORTATION

CONTRACT T201903105.01

(CAD) PAGE 27 OF 56

CANAL

COMMUNITY TRANSPORTATION FUND, NORTH V, 2019

LOCATION 2 EAST MINQUADALE - EAST HAZELDELL AVENUE FROM DOVER STREET TO MILFORD STREET

LENGTH 240.7920 m 790.0000 L.F.

GENERAL IMPROVEMENTS

2" MILL AND OVERLAY(CURB WHERE NECESSARY)

COMMENTS:

INCLUDES INTERSECTION W/ DOVER

MATERIAL ESTIMATE FOR LOCATION 2

211001	REMOVAL OF PORTLAND CEMENT CONCRETE PAVEMENT, CURB AND SIDEWALK	140.00	S.Y.
301002	GRADED AGGREGATE BASE COURSE, TYPE B, PATCHING	25.00	C.Y.
401005	SUPERPAVE TYPE C, PG 64-22 (CARBONATE STONE)	330.00	TON
401029	SUPERPAVE TYPE C, PG 64-22, PATCHING	90.00	TON
402000	BITUMINOUS CONCRETE PATCHING	1,350.00	SY-IN
602130	ADJUSTING AND REPAIRING EXISTING DRAINAGE INLET	2.00	EACH
602132	ADJUSTING AND REPAIRING EXISTING MANHOLE	5.00	EACH
701019	INTEGRAL PORTLAND CEMENT CONCRETE CURB AND GUTTER, TYPE 2	450.00	L.F.
705001	PORTLAND CEMENT CONCRETE SIDEWALK, 4"	180.00	S.F.
705002	PORTLAND CEMENT CONCRETE SIDEWALK, 6"	360.00	S.F.
760010	PAVEMENT MILLING, BITUMINOUS CONCRETE PAVEMENT	5,280.00	SY-IN
762000	SAW CUTTING, BITUMINOUS CONCRETE	675.00	L.F.
762001	SAW CUTTING, CONCRETE, FULL DEPTH	68.00	L.F.
811001	FLAGGER, NEW CASTLE COUNTY STATE	192.00	HOUR
811013	FLAGGER, NEW CASTLE COUNTY, STATE, OVERTIME	19.00	HOUR
908001	TOPSOIL	18.00	TON
908016	PERMANENT GRASS SEEDING, SUBDIVISION	108.00	S.Y.
908020	EROSION CONTROL BLANKET MULCH	108.00	S.Y.

DELAWARE DEPARTMENT OF TRANSPORTATION

CONTRACT T201903105.01

(CAD) PAGE 28 OF 56

CANAL

COMMUNITY TRANSPORTATION FUND, NORTH V, 2019

**LOCATION 3 HARMONY CREST WOODS - DIMINISH DRIVE FROM RED MILL ROAD @
CHANGE IN HOTMIX TO MELODIC DRIVE**

LENGTH 161.5440 m 530.0000 L.F.

GENERAL IMPROVEMENTS

2" MILL AND OVERLAY(CURB WHERE NECESSARY)

COMMENTS:

2 RAMPS @ RED MILL ROAD

MATERIAL ESTIMATE FOR LOCATION 3

211001	REMOVAL OF PORTLAND CEMENT CONCRETE PAVEMENT, CURB AND SIDEWALK	37.00	S.Y.
301002	GRADED AGGREGATE BASE COURSE, TYPE B, PATCHING	7.00	C.Y.
401005	SUPERPAVE TYPE C, PG 64-22 (CARBONATE STONE)	250.00	TON
401029	SUPERPAVE TYPE C, PG 64-22, PATCHING	24.00	TON
401506	SPEED HUMP	32.00	L.F.
402000	BITUMINOUS CONCRETE PATCHING	360.00	SY-IN
602131	ADJUSTING AND REPAIRING EXISTING DOUBLE DRAINAGE INLET	1.00	EACH
602132	ADJUSTING AND REPAIRING EXISTING MANHOLE	2.00	EACH
701019	INTEGRAL PORTLAND CEMENT CONCRETE CURB AND GUTTER, TYPE 2	120.00	L.F.
705001	PORTLAND CEMENT CONCRETE SIDEWALK, 4"	48.00	S.F.
705002	PORTLAND CEMENT CONCRETE SIDEWALK, 6"	96.00	S.F.
705007	SIDEWALK SURFACE DETECTABLE WARNING SYSTEM	20.00	S.F.
705009	PEDESTRIAN CONNECTION, TYPE 2, 3, AND/OR 4	400.00	S.F.
760010	PAVEMENT MILLING, BITUMINOUS CONCRETE PAVEMENT	4,000.00	SY-IN
762000	SAW CUTTING, BITUMINOUS CONCRETE	180.00	L.F.
762001	SAW CUTTING, CONCRETE, FULL DEPTH	18.00	L.F.
802003	ARROW PANELS TYPE C	3.00	EA-DY
808001	FURNISH AND MAINTAIN TRUCK MOUNTED ATTENUATOR, TYPE I	3.00	EA-DY
811001	FLAGGER, NEW CASTLE COUNTY STATE	128.00	HOUR
811013	FLAGGER, NEW CASTLE COUNTY, STATE, OVERTIME	13.00	HOUR
817002	PERMANENT PAVEMENT STRIPING, SYMBOL/LEGEND, ALKYD-THERMOPLASTIC	42.00	S.F.
908001	TOPSOIL	13.00	TON
908016	PERMANENT GRASS SEEDING, SUBDIVISION	78.00	S.Y.
908020	EROSION CONTROL BLANKET MULCH	78.00	S.Y.

DELAWARE DEPARTMENT OF TRANSPORTATION

CONTRACT T201903105.01

(CAD) PAGE 29 OF 56

CANAL

COMMUNITY TRANSPORTATION FUND, NORTH V, 2019

LOCATION 4 HILLSIDE HEIGHTS - STINSFORD ROAD FROM ROSEWOOD DRIVE TO BLACKSTONE ROAD @ CHANGE IN HOTMIX

LENGTH 160.0200 m 525.0000 L.F.

GENERAL IMPROVEMENTS

2" MILL AND OVERLAY(CURB WHERE NECESSARY)

COMMENTS:

MATERIAL ESTIMATE FOR LOCATION 4

211001	REMOVAL OF PORTLAND CEMENT CONCRETE PAVEMENT, CURB AND SIDEWALK	93.00	S.Y.
301002	GRADED AGGREGATE BASE COURSE, TYPE B, PATCHING	17.00	C.Y.
401005	SUPERPAVE TYPE C, PG 64-22 (CARBONATE STONE)	160.00	TON
401029	SUPERPAVE TYPE C, PG 64-22, PATCHING	60.00	TON
401506	SPEED HUMP	22.00	L.F.
402000	BITUMINOUS CONCRETE PATCHING	900.00	SY-IN
504001	CRACK AND JOINT SEALING LESS THAN 3/4 INCH WIDE	44.00	L.F.
602132	ADJUSTING AND REPAIRING EXISTING MANHOLE	3.00	EACH
701019	INTEGRAL PORTLAND CEMENT CONCRETE CURB AND GUTTER, TYPE 2	300.00	L.F.
705001	PORTLAND CEMENT CONCRETE SIDEWALK, 4"	120.00	S.F.
705002	PORTLAND CEMENT CONCRETE SIDEWALK, 6"	240.00	S.F.
760010	PAVEMENT MILLING, BITUMINOUS CONCRETE PAVEMENT	2,560.00	SY-IN
762000	SAW CUTTING, BITUMINOUS CONCRETE	450.00	L.F.
762001	SAW CUTTING, CONCRETE, FULL DEPTH	45.00	L.F.
811001	FLAGGER, NEW CASTLE COUNTY STATE	144.00	HOUR
811013	FLAGGER, NEW CASTLE COUNTY, STATE, OVERTIME	14.00	HOUR
908001	TOPSOIL	12.00	TON
908016	PERMANENT GRASS SEEDING, SUBDIVISION	72.00	S.Y.
908020	EROSION CONTROL BLANKET MULCH	72.00	S.Y.

DELAWARE DEPARTMENT OF TRANSPORTATION

CONTRACT T201903105.01

(CAD) PAGE 30 OF 56

CANAL

COMMUNITY TRANSPORTATION FUND, NORTH V, 2019

LOCATION 5 HOLLINGSWORTH TRACT - HOLLINGSWORTH DRIVE FROM MT. AIRY
DRIVE TO WOODSIDE DRIVE

LENGTH 220.9800 m 725.0000 L.F.

GENERAL IMPROVEMENTS

2" MILL AND OVERLAY

COMMENTS:

INCLUDES INTERSECTION W/ MT AIRY DRIVE

MATERIAL ESTIMATE FOR LOCATION 5

401005	SUPERPAVE TYPE C, PG 64-22 (CARBONATE STONE)	170.00	TON
401030	SUPERPAVE TYPE B, PG 64-22, PATCHING	9.00	TON
402000	BITUMINOUS CONCRETE PATCHING	144.00	SY-IN
760010	PAVEMENT MILLING, BITUMINOUS CONCRETE PAVEMENT	2,720.00	SY-IN
762000	SAW CUTTING, BITUMINOUS CONCRETE	112.00	L.F.
811001	FLAGGER, NEW CASTLE COUNTY STATE	48.00	HOUR
811013	FLAGGER, NEW CASTLE COUNTY, STATE, OVERTIME	5.00	HOUR

DELAWARE DEPARTMENT OF TRANSPORTATION

CONTRACT T201903105.01

(CAD) PAGE 31 OF 56

CANAL

COMMUNITY TRANSPORTATION FUND, NORTH V, 2019

LOCATION 6 HOLLINGSWORTH TRACT - MT. AIRY DRIVE FROM KENNETT PIKE TO
HOLLINGSWORTH DRIVE

LENGTH 109.7280 m 360.0000 L.F.

GENERAL IMPROVEMENTS

2" MILL AND OVERLAY

COMMENTS:

MATERIAL ESTIMATE FOR LOCATION 6

401005	SUPERPAVE TYPE C, PG 64-22 (CARBONATE STONE)	75.00	TON
401030	SUPERPAVE TYPE B, PG 64-22, PATCHING	6.00	TON
402000	BITUMINOUS CONCRETE PATCHING	96.00	SY-IN
760010	PAVEMENT MILLING, BITUMINOUS CONCRETE PAVEMENT	1,200.00	SY-IN
762000	SAW CUTTING, BITUMINOUS CONCRETE	42.00	L.F.
802003	ARROW PANELS TYPE C	2.00	EA-DY
808001	FURNISH AND MAINTAIN TRUCK MOUNTED ATTENUATOR, TYPE I	2.00	EA-DY
811001	FLAGGER, NEW CASTLE COUNTY STATE	32.00	HOUR
811013	FLAGGER, NEW CASTLE COUNTY, STATE, OVERTIME	3.00	HOUR

DELAWARE DEPARTMENT OF TRANSPORTATION

CONTRACT T201903105.01

(CAD) PAGE 33 OF 56

CANAL

COMMUNITY TRANSPORTATION FUND, NORTH V, 2019

LOCATION 8 LANDERS PARK - LANDERS SPUR FROM LANDERS LANE TO I 295
LENGTH
GENERAL IMPROVEMENTS
 ONE SPEED HUMP

COMMENTS:

SPEED HUMP JUST N/O HOUSE #136 LANDERS SPUR

MATERIAL ESTIMATE FOR LOCATION 8

401506	SPEED HUMP	40.00	L.F.
504001	CRACK AND JOINT SEALING LESS THAN 3/4 INCH WIDE	80.00	L.F.
811001	FLAGGER, NEW CASTLE COUNTY STATE	32.00	HOUR
811013	FLAGGER, NEW CASTLE COUNTY, STATE, OVERTIME	3.00	HOUR

UNOFFICIAL
WEBSITE
COPY

DELAWARE DEPARTMENT OF TRANSPORTATION

CONTRACT T201903105.01

(CAD) PAGE 34 OF 56

CANAL

COMMUNITY TRANSPORTATION FUND, NORTH V, 2019

LOCATION 9 LATIMER ESTATES - LATIMER ROAD FROM LATIMER ROAD TO CUL-DE-SAC

LENGTH 76.2000 m 250.0000 L.F.

GENERAL IMPROVEMENTS

TURN HAMMERHEAD INTO A CUL-DE-SAC

COMMENTS:

TURN HAMMERHEAD INTO A CUL-DE-SAC ALSO ENCLOSE DESMOND ROAD DEAD AND WITH TYPE 1 CURB AND CURB OPENING (SEE PLANS - SHEET 34A)

MATERIAL ESTIMATE FOR LOCATION 9

201000	CLEARING AND GRUBBING	1.00	L.S.
202000	EXCAVATION AND EMBANKMENT	80.00	C.Y.
209004	BORROW, TYPE C	20.00	C.Y.
211001	REMOVAL OF PORTLAND CEMENT CONCRETE PAVEMENT, CURB AND SIDEWALK	100.00	S.Y.
211501	TREE REMOVAL, GREATER THAN 15" TO 25" DIAMETER	2.00	EACH
301002	GRADED AGGREGATE BASE COURSE, TYPE B, PATCHING	40.00	C.Y.
401029	SUPERPAVE TYPE C, PG 64-22, PATCHING	55.00	TON
401030	SUPERPAVE TYPE B, PG 64-22, PATCHING	60.00	TON
402000	BITUMINOUS CONCRETE PATCHING	900.00	SY-IN
602130	ADJUSTING AND REPAIRING EXISTING DRAINAGE INLET	1.00	EACH
602132	ADJUSTING AND REPAIRING EXISTING MANHOLE	1.00	EACH
701019	INTEGRAL PORTLAND CEMENT CONCRETE CURB AND GUTTER, TYPE 2	30.00	L.F.
701023	INTEGRAL PORTLAND CEMENT CONCRETE CURB AND GUTTER, TYPE 3-8	230.00	L.F.
701031	CURB OPENING, 2' OPENING	2.00	EACH
705002	PORTLAND CEMENT CONCRETE SIDEWALK, 6"	300.00	S.F.
707001	RIPRAP, R-4	25.00	S.Y.
762000	SAW CUTTING, BITUMINOUS CONCRETE	100.00	L.F.
762001	SAW CUTTING, CONCRETE, FULL DEPTH	20.00	L.F.
763501	CONSTRUCTION ENGINEERING	1.00	L.S.
811001	FLAGGER, NEW CASTLE COUNTY STATE	96.00	HOUR
811013	FLAGGER, NEW CASTLE COUNTY, STATE, OVERTIME	10.00	HOUR
908001	TOPSOIL	20.00	TON
908016	PERMANENT GRASS SEEDING, SUBDIVISION	120.00	S.Y.
908020	EROSION CONTROL BLANKET MULCH	120.00	S.Y.

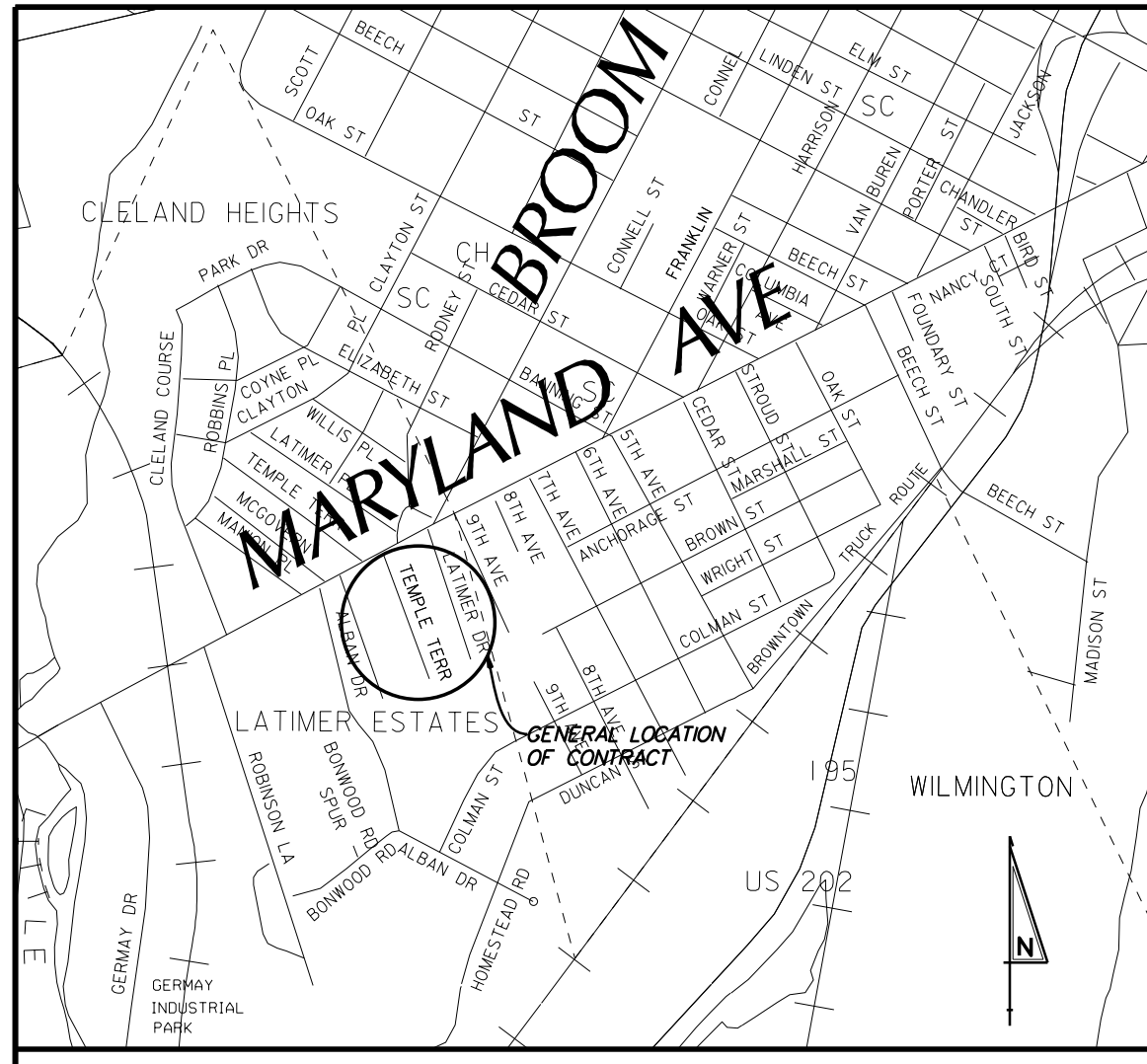

NOTES

1) RIGHT OF WAY LINES ARE APPROXIMATE.

LOCATION MAP - NTS

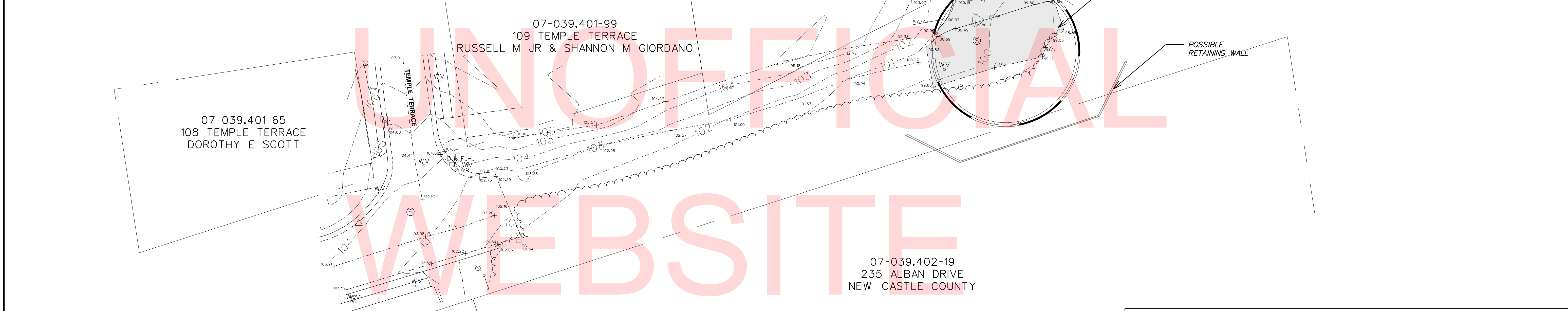

UNOFFICIAL
WEBSITE
COPY

LEGEND

	EXISTING GRADE		FENCE
	PROPOSED GRADE		GUARDRAIL
	DIRECTION OF DITCH FLOW		HEDGE ROW
	MAILBOX		CONIFEROUS TREE
	IRON PIPE		GAS VALVE
	UTILITY POLE		FIRE HYDRANT
	GROUND MOUNTED SIGN		ELECTRICAL JUNCTION BOX
	EXISTING PAVEMENT LINE		LIGHT POLE
	CROWN OF ROAD		SANITARY SEWER
	TOP OF BANK		TRAVERSE POINT
	CROWN OF ROAD		WATER VALVE
	EXISTING RIGHT OF WAY		EXISTING DRAINAGE INLET
	STRIPING		PROPOSED DRAINAGE INLET
	PROPOSED TYPE 3-8 CURB		RIP RAP
			FLARED END SECTION

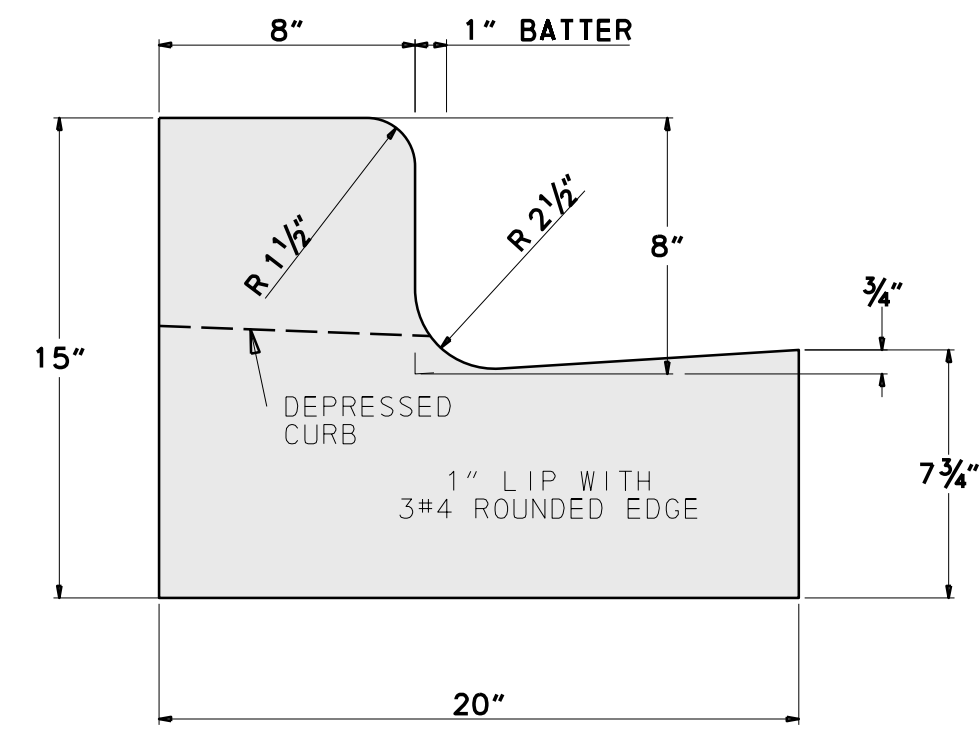

INTEGRAL P.C.C. CURB & GUTTER
TYPE 3-8
NTS

ADDENDUMS / REVISIONS	

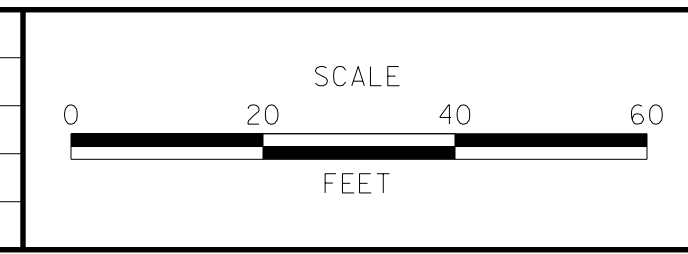

LATIMER DRIVE/DESMOND ROAD EXTENSION

CONTRACT TXXXXXXXXX	BRIDGE NO. X
COUNTY NCC	DESIGNED BY: _____
	CHECKED BY: _____

DELAWARE DEPARTMENT OF TRANSPORTATION

CONTRACT T201903105.01

(CAD) PAGE 35 OF 56

CANAL

COMMUNITY TRANSPORTATION FUND, NORTH V, 2019

LOCATION 10 LITTLE FALLS VILLAGE - NIAGARA FALLS DRIVE FROM PENN OAK DRIVE
LENGTH
GENERAL IMPROVEMENTS
SIDEWALK REPAIRS

COMMENTS:

SIDEWALK REPAIRS ACROSS FROM HOUSE #200 NIAGARA FALLS DRIVE

MATERIAL ESTIMATE FOR LOCATION 10

211001	REMOVAL OF PORTLAND CEMENT CONCRETE PAVEMENT, CURB AND SIDEWALK	18.00	S.Y.
301002	GRADED AGGREGATE BASE COURSE, TYPE B, PATCHING	1.00	C.Y.
401029	SUPERPAVE TYPE C, PG 64-22, PATCHING	3.00	TON
402000	BITUMINOUS CONCRETE PATCHING	42.00	SY-IN
701018	INTEGRAL PORTLAND CEMENT CONCRETE CURB AND GUTTER, TYPE 1-8	20.00	L.F.
705001	PORTLAND CEMENT CONCRETE SIDEWALK, 4"	120.00	S.F.
705007	SIDEWALK SURFACE DETECTABLE WARNING SYSTEM	10.00	S.F.
705009	PEDESTRIAN CONNECTION, TYPE 2, 3, AND/OR 4	200.00	S.F.
762000	SAW CUTTING, BITUMINOUS CONCRETE	74.00	L.F.
762001	SAW CUTTING, CONCRETE, FULL DEPTH	14.00	L.F.
811001	FLAGGER, NEW CASTLE COUNTY STATE	32.00	HOUR
811013	FLAGGER, NEW CASTLE COUNTY, STATE, OVERTIME	3.00	HOUR
908001	TOPSOIL	5.00	TON
908016	PERMANENT GRASS SEEDING, SUBDIVISION	30.00	S.Y.
908020	EROSION CONTROL BLANKET MULCH	30.00	S.Y.

DELAWARE DEPARTMENT OF TRANSPORTATION

CONTRACT T201903105.01

(CAD) PAGE 36 OF 56

CANAL

COMMUNITY TRANSPORTATION FUND, NORTH V, 2019

LOCATION 11 LLANGOLLEN ESTATES - CALLOW PLACE FROM WOODDALE AVENUE TO STERLING AVENUE

LENGTH 103.6320 m 340.0000 L.F.

GENERAL IMPROVEMENTS

2" MILL AND OVERLAY(CURB WHERE NECESSARY)

COMMENTS:

MATERIAL ESTIMATE FOR LOCATION 11

211001	REMOVAL OF PORTLAND CEMENT CONCRETE PAVEMENT, CURB AND SIDEWALK	44.00	S.Y.
301002	GRADED AGGREGATE BASE COURSE, TYPE B, PATCHING	8.00	C.Y.
401005	SUPERPAVE TYPE C, PG 64-22 (CARBONATE STONE)	105.00	TON
401029	SUPERPAVE TYPE C, PG 64-22, PATCHING	28.00	TON
402000	BITUMINOUS CONCRETE PATCHING	420.00	SY-IN
602132	ADJUSTING AND REPAIRING EXISTING MANHOLE	1.00	EACH
701019	INTEGRAL PORTLAND CEMENT CONCRETE CURB AND GUTTER, TYPE 2	140.00	L.F.
705001	PORTLAND CEMENT CONCRETE SIDEWALK, 4"	56.00	S.F.
705002	PORTLAND CEMENT CONCRETE SIDEWALK, 6"	112.00	S.F.
760010	PAVEMENT MILLING, BITUMINOUS CONCRETE PAVEMENT	1,680.00	SY-IN
762000	SAW CUTTING, BITUMINOUS CONCRETE	210.00	L.F.
762001	SAW CUTTING, CONCRETE, FULL DEPTH	21.00	L.F.
811001	FLAGGER, NEW CASTLE COUNTY STATE	64.00	HOUR
811013	FLAGGER, NEW CASTLE COUNTY, STATE, OVERTIME	6.00	HOUR
908001	TOPSOIL	6.00	TON
908016	PERMANENT GRASS SEEDING, SUBDIVISION	36.00	S.Y.
908020	EROSION CONTROL BLANKET MULCH	36.00	S.Y.

DELAWARE DEPARTMENT OF TRANSPORTATION

CONTRACT T201903105.01

(CAD) PAGE 37 OF 56

CANAL

COMMUNITY TRANSPORTATION FUND, NORTH V, 2019

LOCATION 12 LLANGOLLEN ESTATES - STERLING AVENUE FROM DUDLEY PLACE TO
CUL-DE-SAC

LENGTH 137.1600 m 450.0000 L.F.

GENERAL IMPROVEMENTS

2" MILL AND OVERLAY(CURB WHERE NECESSARY)

COMMENTS:

MATERIAL ESTIMATE FOR LOCATION 12

211001	REMOVAL OF PORTLAND CEMENT CONCRETE PAVEMENT, CURB AND SIDEWALK	47.00	S.Y.
301002	GRADED AGGREGATE BASE COURSE, TYPE B, PATCHING	8.00	C.Y.
401005	SUPERPAVE TYPE C, PG 64-22 (CARBONATE STONE)	200.00	TON
401029	SUPERPAVE TYPE C, PG 64-22, PATCHING	30.00	TON
402000	BITUMINOUS CONCRETE PATCHING	450.00	SY-IN
602131	ADJUSTING AND REPAIRING EXISTING DOUBLE DRAINAGE INLET	1.00	EACH
602132	ADJUSTING AND REPAIRING EXISTING MANHOLE	3.00	EACH
701019	INTEGRAL PORTLAND CEMENT CONCRETE CURB AND GUTTER, TYPE 2	150.00	L.F.
705001	PORTLAND CEMENT CONCRETE SIDEWALK, 4"	60.00	S.F.
705002	PORTLAND CEMENT CONCRETE SIDEWALK, 6"	120.00	S.F.
760010	PAVEMENT MILLING, BITUMINOUS CONCRETE PAVEMENT	3,200.00	SY-IN
760011	PAVEMENT MILLING, BITUMINOUS CONCRETE PAVEMENT, TAPER CUT	385.00	SY-IN
762000	SAW CUTTING, BITUMINOUS CONCRETE	225.00	L.F.
762001	SAW CUTTING, CONCRETE, FULL DEPTH	23.00	L.F.
762004	BUTT JOINTS	100.00	S.Y.
811001	FLAGGER, NEW CASTLE COUNTY STATE	96.00	HOURL
811013	FLAGGER, NEW CASTLE COUNTY, STATE, OVERTIME	10.00	HOURL
908001	TOPSOIL	6.00	TON
908016	PERMANENT GRASS SEEDING, SUBDIVISION	36.00	S.Y.
908020	EROSION CONTROL BLANKET MULCH	36.00	S.Y.

DELAWARE DEPARTMENT OF TRANSPORTATION

CONTRACT T201903105.01

(CAD) PAGE 38 OF 56

CANAL

COMMUNITY TRANSPORTATION FUND, NORTH V, 2019

LOCATION 13 LLANGOLLEN ESTATES - STERLING AVENUE FROM GORDY PLACE TO CALLOW PLACE

LENGTH 437.3880 m 1435.0000 L.F.

GENERAL IMPROVEMENTS

2" MILL AND OVERLAY(CURB WHERE NECESSARY)

COMMENTS:

MATERIAL ESTIMATE FOR LOCATION 13

211001	REMOVAL OF PORTLAND CEMENT CONCRETE PAVEMENT, CURB AND SIDEWALK	165.00	S.Y.
301002	GRADED AGGREGATE BASE COURSE, TYPE B, PATCHING	29.00	C.Y.
401005	SUPERPAVE TYPE C, PG 64-22 (CARBONATE STONE)	440.00	TON
401029	SUPERPAVE TYPE C, PG 64-22, PATCHING	106.00	TON
401506	SPEED HUMP	66.00	L.F.
402000	BITUMINOUS CONCRETE PATCHING	1,590.00	SY-IN
504001	CRACK AND JOINT SEALING LESS THAN 3/4 INCH WIDE	132.00	L.F.
602130	ADJUSTING AND REPAIRING EXISTING DRAINAGE INLET	1.00	EACH
602131	ADJUSTING AND REPAIRING EXISTING DOUBLE DRAINAGE INLET	1.00	EACH
602132	ADJUSTING AND REPAIRING EXISTING MANHOLE	6.00	EACH
701019	INTEGRAL PORTLAND CEMENT CONCRETE CURB AND GUTTER, TYPE 2	530.00	L.F.
705001	PORTLAND CEMENT CONCRETE SIDEWALK, 4"	212.00	S.F.
705002	PORTLAND CEMENT CONCRETE SIDEWALK, 6"	424.00	S.F.
760010	PAVEMENT MILLING, BITUMINOUS CONCRETE PAVEMENT	7,040.00	SY-IN
762000	SAW CUTTING, BITUMINOUS CONCRETE	795.00	L.F.
762001	SAW CUTTING, CONCRETE, FULL DEPTH	80.00	L.F.
811001	FLAGGER, NEW CASTLE COUNTY STATE	256.00	HOURLY
811013	FLAGGER, NEW CASTLE COUNTY, STATE, OVERTIME	26.00	HOURLY
908001	TOPSOIL	21.00	TON
908016	PERMANENT GRASS SEEDING, SUBDIVISION	126.00	S.Y.
908020	EROSION CONTROL BLANKET MULCH	126.00	S.Y.

DELAWARE DEPARTMENT OF TRANSPORTATION

CONTRACT T201903105.01

(CAD) PAGE 40 OF 56

CANAL

COMMUNITY TRANSPORTATION FUND, NORTH V, 2019

LOCATION 15 **RAMSEY RIDGE - DEWBERRY FROM HOUSE #106 DEWBERRY (JOINT
NEAR TWO LANES) TO HOUSE #136 DEWBERRY (DRIVEWAY)**

LENGTH 448.0560 m 1470.0000 L.F.

GENERAL IMPROVEMENTS

2" MILL AND OVERLAY(CURB WHERE NECESSARY)

COMMENTS:

MATERIAL ESTIMATE FOR LOCATION 15

401005	SUPERPAVE TYPE C, PG 64-22 (CARBONATE STONE)	750.00	TON
401030	SUPERPAVE TYPE B, PG 64-22, PATCHING	15.00	TON
402000	BITUMINOUS CONCRETE PATCHING	240.00	SY-IN
602132	ADJUSTING AND REPAIRING EXISTING MANHOLE	1.00	EACH
710002	ADJUST WATER VALVE BOXES	1.00	EACH
760010	PAVEMENT MILLING, BITUMINOUS CONCRETE PAVEMENT	12,000.00	SY-IN
762000	SAW CUTTING, BITUMINOUS CONCRETE	224.00	L.F.
811001	FLAGGER, NEW CASTLE COUNTY STATE	128.00	HOUR
811013	FLAGGER, NEW CASTLE COUNTY, STATE, OVERTIME	13.00	HOUR

DELAWARE DEPARTMENT OF TRANSPORTATION

CONTRACT T201903105.01

(CAD) PAGE 41 OF 56

CANAL

COMMUNITY TRANSPORTATION FUND, NORTH V, 2019

LOCATION 16 RIVERS END - BYNUM COURT WEST FROM BYNUM PLACE WEST TO CUL-DE-SAC

LENGTH 32.0040 m 105.0000 L.F.

GENERAL IMPROVEMENTS

2" MILL AND OVERLAY(CURB WHERE NECESSARY)

COMMENTS:

MATERIAL ESTIMATE FOR LOCATION 16

211001	REMOVAL OF PORTLAND CEMENT CONCRETE PAVEMENT, CURB AND SIDEWALK	12.00	S.Y.
301002	GRADED AGGREGATE BASE COURSE, TYPE B, PATCHING	2.00	C.Y.
401005	SUPERPAVE TYPE C, PG 64-22 (CARBONATE STONE)	100.00	TON
401029	SUPERPAVE TYPE C, PG 64-22, PATCHING	8.00	TON
402000	BITUMINOUS CONCRETE PATCHING	120.00	SY-IN
602132	ADJUSTING AND REPAIRING EXISTING MANHOLE	1.00	EACH
701019	INTEGRAL PORTLAND CEMENT CONCRETE CURB AND GUTTER, TYPE 2	40.00	L.F.
705001	PORTLAND CEMENT CONCRETE SIDEWALK, 4"	16.00	S.F.
705002	PORTLAND CEMENT CONCRETE SIDEWALK, 6"	32.00	S.F.
760010	PAVEMENT MILLING, BITUMINOUS CONCRETE PAVEMENT	300.00	SY-IN
760011	PAVEMENT MILLING, BITUMINOUS CONCRETE PAVEMENT, TAPER CUT	385.00	SY-IN
762000	SAW CUTTING, BITUMINOUS CONCRETE	60.00	L.F.
762001	SAW CUTTING, CONCRETE, FULL DEPTH	6.00	L.F.
811001	FLAGGER, NEW CASTLE COUNTY STATE	48.00	HOUR
811013	FLAGGER, NEW CASTLE COUNTY, STATE, OVERTIME	5.00	HOUR
908001	TOPSOIL	2.00	TON
908016	PERMANENT GRASS SEEDING, SUBDIVISION	12.00	S.Y.
908020	EROSION CONTROL BLANKET MULCH	12.00	S.Y.

DELAWARE DEPARTMENT OF TRANSPORTATION

CONTRACT T201903105.01

(CAD) PAGE 42 OF 56

CANAL

COMMUNITY TRANSPORTATION FUND, NORTH V, 2019

LOCATION 17 RIVERS END - BYNUM PLACE WEST FROM BYNUM PLACE TO CUL-DE-SAC

LENGTH 160.0200 m 525.0000 L.F.

GENERAL IMPROVEMENTS

2" MILL AND OVERLAY(CURB WHERE NECESSARY)

COMMENTS:

MATERIAL ESTIMATE FOR LOCATION 17

211001	REMOVAL OF PORTLAND CEMENT CONCRETE PAVEMENT, CURB AND SIDEWALK	93.00	S.Y.
301002	GRADED AGGREGATE BASE COURSE, TYPE B, PATCHING	17.00	C.Y.
401005	SUPERPAVE TYPE C, PG 64-22 (CARBONATE STONE)	225.00	TON
401029	SUPERPAVE TYPE C, PG 64-22, PATCHING	60.00	TON
402000	BITUMINOUS CONCRETE PATCHING	900.00	SY-IN
602132	ADJUSTING AND REPAIRING EXISTING MANHOLE	2.00	EACH
701019	INTEGRAL PORTLAND CEMENT CONCRETE CURB AND GUTTER, TYPE 2	300.00	L.F.
705001	PORTLAND CEMENT CONCRETE SIDEWALK, 4"	120.00	S.F.
705002	PORTLAND CEMENT CONCRETE SIDEWALK, 6"	240.00	S.F.
760010	PAVEMENT MILLING, BITUMINOUS CONCRETE PAVEMENT	3,600.00	SY-IN
760011	PAVEMENT MILLING, BITUMINOUS CONCRETE PAVEMENT, TAPER CUT	385.00	SY-IN
762000	SAW CUTTING, BITUMINOUS CONCRETE	450.00	L.F.
762001	SAW CUTTING, CONCRETE, FULL DEPTH	45.00	L.F.
811001	FLAGGER, NEW CASTLE COUNTY STATE	128.00	HOUR
811013	FLAGGER, NEW CASTLE COUNTY, STATE, OVERTIME	13.00	HOUR
908001	TOPSOIL	12.00	TON
908016	PERMANENT GRASS SEEDING, SUBDIVISION	72.00	S.Y.
908020	EROSION CONTROL BLANKET MULCH	72.00	S.Y.

DELAWARE DEPARTMENT OF TRANSPORTATION

CONTRACT T201903105.01

(CAD) PAGE 43 OF 56

CANAL

COMMUNITY TRANSPORTATION FUND, NORTH V, 2019

LOCATION 18 RIVERS END - DEEP CREEK TERRACE FROM END OF DEEP CREEK
TERRACE TO END OF DEEP CREEK TERRACE

LENGTH 10.6680 m 35.0000 L.F.

GENERAL IMPROVEMENTS

CONNECTION TO CREATE SECOND ENTRANCE TO DEVELOPMENTS

COMMENTS:

CONNECT DEEP CREEK TERRACE TO RIVERS END DRIVE (SEE PLANS - SHEET 43A)

MATERIAL ESTIMATE FOR LOCATION 18

201000	CLEARING AND GRUBBING	1.00	L.S.
202000	EXCAVATION AND EMBANKMENT	60.00	C.Y.
211001	REMOVAL OF PORTLAND CEMENT CONCRETE PAVEMENT, CURB AND SIDEWALK	90.00	S.Y.
301002	GRADED AGGREGATE BASE COURSE, TYPE B, PATCHING	30.00	C.Y.
401029	SUPERPAVE TYPE C, PG 64-22, PATCHING	20.00	TON
401030	SUPERPAVE TYPE B, PG 64-22, PATCHING	30.00	TON
602132	ADJUSTING AND REPAIRING EXISTING MANHOLE	1.00	EACH
701019	INTEGRAL PORTLAND CEMENT CONCRETE CURB AND GUTTER, TYPE 2	160.00	L.F.
705001	PORTLAND CEMENT CONCRETE SIDEWALK, 4"	50.00	S.F.
705002	PORTLAND CEMENT CONCRETE SIDEWALK, 6"	120.00	S.F.
705007	SIDEWALK SURFACE DETECTABLE WARNING SYSTEM	20.00	S.F.
705009	PEDESTRIAN CONNECTION, TYPE 2, 3, AND/OR 4	400.00	S.F.
762000	SAW CUTTING, BITUMINOUS CONCRETE	100.00	L.F.
762001	SAW CUTTING, CONCRETE, FULL DEPTH	50.00	L.F.
763501	CONSTRUCTION ENGINEERING	1.00	L.S.
811001	FLAGGER, NEW CASTLE COUNTY STATE	176.00	HOUR
811013	FLAGGER, NEW CASTLE COUNTY, STATE, OVERTIME	18.00	HOUR
817002	PERMANENT PAVEMENT STRIPING, SYMBOL/LEGEND, ALKYD-THERMOPLASTIC	360.00	S.F.
908001	TOPSOIL	20.00	TON
908016	PERMANENT GRASS SEEDING, SUBDIVISION	120.00	S.Y.
908020	EROSION CONTROL BLANKET MULCH	120.00	S.Y.

DELAWARE DEPARTMENT OF TRANSPORTATION

CONTRACT T201903105.01

(CAD) PAGE 44 OF 56

CANAL

COMMUNITY TRANSPORTATION FUND, NORTH V, 2019

LOCATION 19 RIVERS END - SAWMILL BRIDGE LANE FROM MILL CREEK LANE TO PROVIDENCE DRIVE

LENGTH 138.6840 m 455.0000 L.F.

GENERAL IMPROVEMENTS

2" MILL AND OVERLAY(CURB WHERE NECESSARY)

COMMENTS:

MATERIAL ESTIMATE FOR LOCATION 19

211001	REMOVAL OF PORTLAND CEMENT CONCRETE PAVEMENT, CURB AND SIDEWALK	75.00	S.Y.
301002	GRADED AGGREGATE BASE COURSE, TYPE B, PATCHING	13.00	C.Y.
401005	SUPERPAVE TYPE C, PG 64-22 (CARBONATE STONE)	140.00	TON
401029	SUPERPAVE TYPE C, PG 64-22, PATCHING	48.00	TON
402000	BITUMINOUS CONCRETE PATCHING	720.00	SY-IN
602130	ADJUSTING AND REPAIRING EXISTING DRAINAGE INLET	2.00	EACH
602132	ADJUSTING AND REPAIRING EXISTING MANHOLE	2.00	EACH
701019	INTEGRAL PORTLAND CEMENT CONCRETE CURB AND GUTTER, TYPE 2	240.00	L.F.
705001	PORTLAND CEMENT CONCRETE SIDEWALK, 4"	96.00	S.F.
705002	PORTLAND CEMENT CONCRETE SIDEWALK, 6"	192.00	S.F.
760010	PAVEMENT MILLING, BITUMINOUS CONCRETE PAVEMENT	2,240.00	SY-IN
762000	SAW CUTTING, BITUMINOUS CONCRETE	360.00	L.F.
762001	SAW CUTTING, CONCRETE, FULL DEPTH	36.00	L.F.
811001	FLAGGER, NEW CASTLE COUNTY STATE	128.00	HOUR
811013	FLAGGER, NEW CASTLE COUNTY, STATE, OVERTIME	13.00	HOUR
908001	TOPSOIL	10.00	TON
908016	PERMANENT GRASS SEEDING, SUBDIVISION	60.00	S.Y.
908020	EROSION CONTROL BLANKET MULCH	60.00	S.Y.

DELAWARE DEPARTMENT OF TRANSPORTATION

CONTRACT T201903105.01

(CAD) PAGE 45 OF 56

CANAL

COMMUNITY TRANSPORTATION FUND, NORTH V, 2019

LOCATION 20 RIVERS END - SCOTT RUN COURT FROM SCOTT RUN CIRCLE TO CUL-DE-SAC

LENGTH 35.0520 m 115.0000 L.F.

GENERAL IMPROVEMENTS

2" MILL AND OVERLAY(CURB WHERE NECESSARY)

COMMENTS:

MATERIAL ESTIMATE FOR LOCATION 20

211001	REMOVAL OF PORTLAND CEMENT CONCRETE PAVEMENT, CURB AND SIDEWALK	4.00	S.Y.
301002	GRADED AGGREGATE BASE COURSE, TYPE B, PATCHING	1.00	C.Y.
401005	SUPERPAVE TYPE C, PG 64-22 (CARBONATE STONE)	105.00	TON
401029	SUPERPAVE TYPE C, PG 64-22, PATCHING	4.00	TON
402000	BITUMINOUS CONCRETE PATCHING	60.00	SY-IN
602132	ADJUSTING AND REPAIRING EXISTING MANHOLE	1.00	EACH
701019	INTEGRAL PORTLAND CEMENT CONCRETE CURB AND GUTTER, TYPE 2	20.00	L.F.
705001	PORTLAND CEMENT CONCRETE SIDEWALK, 4"	8.00	S.F.
705002	PORTLAND CEMENT CONCRETE SIDEWALK, 6"	16.00	S.F.
710002	ADJUST WATER VALVE BOXES	1.00	EACH
760010	PAVEMENT MILLING, BITUMINOUS CONCRETE PAVEMENT	570.00	SY-IN
760011	PAVEMENT MILLING, BITUMINOUS CONCRETE PAVEMENT, TAPER CUT	385.00	SY-IN
762000	SAW CUTTING, BITUMINOUS CONCRETE	30.00	L.F.
762001	SAW CUTTING, CONCRETE, FULL DEPTH	3.00	L.F.
811001	FLAGGER, NEW CASTLE COUNTY STATE	64.00	HOUR
811013	FLAGGER, NEW CASTLE COUNTY, STATE, OVERTIME	6.00	HOUR
908001	TOPSOIL	5.00	TON
908016	PERMANENT GRASS SEEDING, SUBDIVISION	30.00	S.Y.
908020	EROSION CONTROL BLANKET MULCH	30.00	S.Y.

DELAWARE DEPARTMENT OF TRANSPORTATION

CONTRACT T201903105.01

(CAD) PAGE 46 OF 56

CANAL

COMMUNITY TRANSPORTATION FUND, NORTH V, 2019

LOCATION 21 TAYLORTOWNE - POE WAY FROM RIVERS END DRIVE / TAYLOR DRIVE @ CHANGE IN HOTMIX TO ARCHER WAY

LENGTH 109.7280 m 360.0000 L.F.

GENERAL IMPROVEMENTS

2" MILL AND OVERLAY(CURB WHERE NECESSARY)

COMMENTS:

INCLUDES INTERSECTION W/ ARCHER - 2 RAMPS @ ARCHER (RAMPS WERE RECENTLY UPDATED PER KCI REVIEW 2/10/19)

MATERIAL ESTIMATE FOR LOCATION 21

211001	REMOVAL OF PORTLAND CEMENT CONCRETE PAVEMENT, CURB AND SIDEWALK	62.00	S.Y.
301002	GRADED AGGREGATE BASE COURSE, TYPE B, PATCHING	11.00	C.Y.
401005	SUPERPAVE TYPE C, PG 64-22 (CARBONATE STONE)	120.00	TON
401029	SUPERPAVE TYPE C, PG 64-22, PATCHING	40.00	TON
402000	BITUMINOUS CONCRETE PATCHING	600.00	SY-IN
602132	ADJUSTING AND REPAIRING EXISTING MANHOLE	1.00	EACH
701013	PORTLAND CEMENT CONCRETE CURB, TYPE 1-8	20.00	L.F.
701019	INTEGRAL PORTLAND CEMENT CONCRETE CURB AND GUTTER, TYPE 2	200.00	L.F.
705001	PORTLAND CEMENT CONCRETE SIDEWALK, 4"	80.00	S.F.
705002	PORTLAND CEMENT CONCRETE SIDEWALK, 6"	160.00	S.F.
760010	PAVEMENT MILLING, BITUMINOUS CONCRETE PAVEMENT	1,920.00	SY-IN
762000	SAW CUTTING, BITUMINOUS CONCRETE	300.00	L.F.
762001	SAW CUTTING, CONCRETE, FULL DEPTH	30.00	L.F.
811001	FLAGGER, NEW CASTLE COUNTY STATE	96.00	HOUR
811013	FLAGGER, NEW CASTLE COUNTY, STATE, OVERTIME	10.00	HOUR
908001	TOPSOIL	8.00	TON
908016	PERMANENT GRASS SEEDING, SUBDIVISION	48.00	S.Y.
908020	EROSION CONTROL BLANKET MULCH	48.00	S.Y.

DELAWARE DEPARTMENT OF TRANSPORTATION

CONTRACT T201903105.01

(CAD) PAGE 47 OF 56

CANAL

COMMUNITY TRANSPORTATION FUND, NORTH V, 2019

LOCATION 22 WEDGEWOOD - DUQUESNE COURT FROM T-INTERSECTION OF DUQUESNE COURT

LENGTH 3.0480 m 10.0000 L.F.

GENERAL IMPROVEMENTS

REPAIR VALLEY GUTTER

COMMENTS:

MATERIAL ESTIMATE FOR LOCATION 22

211001	REMOVAL OF PORTLAND CEMENT CONCRETE PAVEMENT, CURB AND SIDEWALK	50.00	S.Y.
301001	GRADED AGGREGATE BASE COURSE, TYPE B	18.00	C.Y.
401029	SUPERPAVE TYPE C, PG 64-22, PATCHING	10.00	TON
402000	BITUMINOUS CONCRETE PATCHING	240.00	SY-IN
501001	PORTLAND CEMENT CONCRETE PAVEMENT, 8"	50.00	S.Y.
504001	CRACK AND JOINT SEALING LESS THAN 3/4 INCH WIDE	100.00	L.F.
762000	SAW CUTTING, BITUMINOUS CONCRETE	120.00	L.F.
762001	SAW CUTTING, CONCRETE, FULL DEPTH	12.00	L.F.
811001	FLAGGER, NEW CASTLE COUNTY STATE	48.00	HOUR
811013	FLAGGER, NEW CASTLE COUNTY, STATE, OVERTIME	5.00	HOUR
908001	TOPSOIL	4.00	TON
908016	PERMANENT GRASS SEEDING, SUBDIVISION	24.00	S.Y.
908020	EROSION CONTROL BLANKET MULCH	24.00	S.Y.

DELAWARE DEPARTMENT OF TRANSPORTATION

CONTRACT T201903105.01

(CAD) PAGE 48 OF 56

CANAL

COMMUNITY TRANSPORTATION FUND, NORTH V, 2019

LOCATION 23 WESTGATE FARMS - WESTGATE DR FROM LOVEVILLE ROAD TO CARDEW COURT (NEW HOTMIX @ HOUSE #128)

LENGTH 210.3120 m 690.0000 L.F.

GENERAL IMPROVEMENTS

2" MILL AND OVERLAY(CURB WHERE NECESSARY)

COMMENTS:

REPLACE SPEEDHUMPS W/ 4" PROFILE

MATERIAL ESTIMATE FOR LOCATION 23

211001	REMOVAL OF PORTLAND CEMENT CONCRETE PAVEMENT, CURB AND SIDEWALK	224.00	S.Y.
301002	GRADED AGGREGATE BASE COURSE, TYPE B, PATCHING	40.00	C.Y.
401005	SUPERPAVE TYPE C, PG 64-22 (CARBONATE STONE)	360.00	TON
401029	SUPERPAVE TYPE C, PG 64-22, PATCHING	144.00	TON
401506	SPEED HUMP	64.00	L.F.
402000	BITUMINOUS CONCRETE PATCHING	2,160.00	SY-IN
504001	CRACK AND JOINT SEALING LESS THAN 3/4 INCH WIDE	128.00	L.F.
602100	REPLACE DRAINAGE INLET GRATE(S)	8.00	EACH
602101	REPLACE DRAINAGE INLET FRAME(S)	8.00	EACH
602130	ADJUSTING AND REPAIRING EXISTING DRAINAGE INLET	8.00	EACH
602132	ADJUSTING AND REPAIRING EXISTING MANHOLE	3.00	EACH
701019	INTEGRAL PORTLAND CEMENT CONCRETE CURB AND GUTTER, TYPE 2	720.00	L.F.
705001	PORTLAND CEMENT CONCRETE SIDEWALK, 4"	288.00	S.F.
705002	PORTLAND CEMENT CONCRETE SIDEWALK, 6"	576.00	S.F.
760010	PAVEMENT MILLING, BITUMINOUS CONCRETE PAVEMENT	5,760.00	SY-IN
762000	SAW CUTTING, BITUMINOUS CONCRETE	1,080.00	L.F.
762001	SAW CUTTING, CONCRETE, FULL DEPTH	108.00	L.F.
802003	ARROW PANELS TYPE C	4.00	EA-DY
808001	FURNISH AND MAINTAIN TRUCK MOUNTED ATTENUATOR, TYPE I	4.00	EA-DY
811001	FLAGGER, NEW CASTLE COUNTY STATE	304.00	HOUR
811013	FLAGGER, NEW CASTLE COUNTY, STATE, OVERTIME	30.00	HOUR
905004	INLET SEDIMENT CONTROL, DRAINAGE INLET	8.00	EACH
908001	TOPSOIL	30.00	TON
908016	PERMANENT GRASS SEEDING, SUBDIVISION	240.00	S.Y.
908020	EROSION CONTROL BLANKET MULCH	240.00	S.Y.

DELAWARE DEPARTMENT OF TRANSPORTATION

CONTRACT T201903105.01

(CAD) PAGE 49 OF 56

CANAL

COMMUNITY TRANSPORTATION FUND, NORTH V, 2019

LOCATION 24

WESTGATE FARMS - WESTGATE DRIVE FROM LANCASTER PIKE TO
OLDBURY DRIVE

LENGTH

GENERAL IMPROVEMENTS

SPEED HUMPS

COMMENTS:

REPLACE SPEEDHUMPS W/ 4" PROFILE

MATERIAL ESTIMATE FOR LOCATION 24

401506	SPEED HUMP	64.00	L.F.
504001	CRACK AND JOINT SEALING LESS THAN 3/4 INCH WIDE	128.00	L.F.
811001	FLAGGER, NEW CASTLE COUNTY STATE	32.00	HOUR
811013	FLAGGER, NEW CASTLE COUNTY, STATE, OVERTIME	3.00	HOUR

UNOFFICIAL
WEBSITE
COPY

DELAWARE DEPARTMENT OF TRANSPORTATION

CONTRACT T201903105.01

(CAD) PAGE 50 OF 56

CANAL

COMMUNITY TRANSPORTATION FUND, NORTH V, 2019

LOCATION 25 WESTGATE FARMS - WESTGATE DRIVE FROM NEW HOTMIX @ HOUSE #126 TO OLDBURY DRIVE

LENGTH 246.8880 m 810.0000 L.F.

GENERAL IMPROVEMENTS

2" MILL AND OVERLAY (CURB WHERE NECESSARY)

COMMENTS:

REPLACE SPEEDHUMPS W/ 4" PROFILE

MATERIAL ESTIMATE FOR LOCATION 25

211001	REMOVAL OF PORTLAND CEMENT CONCRETE PAVEMENT, CURB AND SIDEWALK	112.00	S.Y.
301002	GRADED AGGREGATE BASE COURSE, TYPE B, PATCHING	19.00	C.Y.
401005	SUPERPAVE TYPE C, PG 64-22 (CARBONATE STONE)	375.00	TON
401029	SUPERPAVE TYPE C, PG 64-22, PATCHING	160.00	TON
401506	SPEED HUMP	64.00	L.F.
402000	BITUMINOUS CONCRETE PATCHING	2,400.00	SY-IN
504001	CRACK AND JOINT SEALING LESS THAN 3/4 INCH WIDE	128.00	L.F.
602130	ADJUSTING AND REPAIRING EXISTING DRAINAGE INLET	3.00	EACH
602132	ADJUSTING AND REPAIRING EXISTING MANHOLE	5.00	EACH
701019	INTEGRAL PORTLAND CEMENT CONCRETE CURB AND GUTTER, TYPE 2	360.00	L.F.
705001	PORTLAND CEMENT CONCRETE SIDEWALK, 4"	159.00	S.F.
705002	PORTLAND CEMENT CONCRETE SIDEWALK, 6"	318.00	S.F.
710370	STEEL CASING PIPE, 4"	10.00	L.F.
760010	PAVEMENT MILLING, BITUMINOUS CONCRETE PAVEMENT	6,000.00	SY-IN
762000	SAW CUTTING, BITUMINOUS CONCRETE	500.00	L.F.
762001	SAW CUTTING, CONCRETE, FULL DEPTH	50.00	L.F.
811001	FLAGGER, NEW CASTLE COUNTY STATE	256.00	HOURLY
811013	FLAGGER, NEW CASTLE COUNTY, STATE, OVERTIME	26.00	HOURLY
908001	TOPSOIL	18.00	TON
908016	PERMANENT GRASS SEEDING, SUBDIVISION	108.00	S.Y.
908020	EROSION CONTROL BLANKET MULCH	108.00	S.Y.

DELAWARE DEPARTMENT OF TRANSPORTATION

CONTRACT T201903105.01

(CAD) PAGE 51 OF 56

CANAL

COMMUNITY TRANSPORTATION FUND, NORTH V, 2019

LOCATION 26 WESTOVER HILLS - ESSEX ROAD WEST FROM PRINCETON RD TO
GREENWOOD RD

LENGTH 155.4480 m 510.0000 L.F.

GENERAL IMPROVEMENTS

2" MILL AND OVERLAY

COMMENTS:

CURB RECENTLY REPLACED (ESTIMATE 16-848)

MATERIAL ESTIMATE FOR LOCATION 26

401005	SUPERPAVE TYPE C, PG 64-22 (CARBONATE STONE)	115.00	TON
401030	SUPERPAVE TYPE B, PG 64-22, PATCHING	9.00	TON
402000	BITUMINOUS CONCRETE PATCHING	144.00	SY-IN
602132	ADJUSTING AND REPAIRING EXISTING MANHOLE	1.00	EACH
760010	PAVEMENT MILLING, BITUMINOUS CONCRETE PAVEMENT	1,840.00	SY-IN
811001	FLAGGER, NEW CASTLE COUNTY STATE	48.00	HOUR
811013	FLAGGER, NEW CASTLE COUNTY, STATE, OVERTIME	5.00	HOUR

DELAWARE DEPARTMENT OF TRANSPORTATION

CONTRACT T201903105.01

(CAD) PAGE 52 OF 56

CANAL

COMMUNITY TRANSPORTATION FUND, NORTH V, 2019

LOCATION 27 WESTOVER HILLS - PRINCETON RD FROM HOPETON RD @ CHANGE IN HOTMIX TO NORTH DUPONT RD

LENGTH 190.5000 m 625.0000 L.F.

GENERAL IMPROVEMENTS

2" MILL AND OVERLAY(CURB WHERE NECESSARY)

COMMENTS:

2 RAMPS @ N DUPONT

MATERIAL ESTIMATE FOR LOCATION 27

211001	REMOVAL OF PORTLAND CEMENT CONCRETE PAVEMENT, CURB AND SIDEWALK	370.00	S.Y.
301002	GRADED AGGREGATE BASE COURSE, TYPE B, PATCHING	70.00	C.Y.
401005	SUPERPAVE TYPE C, PG 64-22 (CARBONATE STONE)	175.00	TON
401029	SUPERPAVE TYPE C, PG 64-22, PATCHING	240.00	TON
402000	BITUMINOUS CONCRETE PATCHING	3,600.00	SY-IN
602132	ADJUSTING AND REPAIRING EXISTING MANHOLE	3.00	EACH
701019	INTEGRAL PORTLAND CEMENT CONCRETE CURB AND GUTTER, TYPE 2	1,200.00	L.F.
705001	PORTLAND CEMENT CONCRETE SIDEWALK, 4"	480.00	S.F.
705002	PORTLAND CEMENT CONCRETE SIDEWALK, 6"	960.00	S.F.
705007	SIDEWALK SURFACE DETECTABLE WARNING SYSTEM	20.00	S.F.
705009	PEDESTRIAN CONNECTION, TYPE 2, 3, AND/OR 4	400.00	S.F.
710370	STEEL CASING PIPE, 4"	50.00	L.F.
760010	PAVEMENT MILLING, BITUMINOUS CONCRETE PAVEMENT	2,800.00	SY-IN
762000	SAW CUTTING, BITUMINOUS CONCRETE	1,800.00	L.F.
762001	SAW CUTTING, CONCRETE, FULL DEPTH	180.00	L.F.
802003	ARROW PANELS TYPE C	5.00	EA-DY
808001	FURNISH AND MAINTAIN TRUCK MOUNTED ATTENUATOR, TYPE I	5.00	EA-DY
811001	FLAGGER, NEW CASTLE COUNTY STATE	384.00	HOURLY
811013	FLAGGER, NEW CASTLE COUNTY, STATE, OVERTIME	38.00	HOURLY
908001	TOPSOIL	130.00	TON
908016	PERMANENT GRASS SEEDING, SUBDIVISION	780.00	S.Y.
908020	EROSION CONTROL BLANKET MULCH	780.00	S.Y.

DELAWARE DEPARTMENT OF TRANSPORTATION

CONTRACT T201903105.01

(CAD) PAGE 53 OF 56

CANAL

COMMUNITY TRANSPORTATION FUND, NORTH V, 2019

LOCATION 28 **WESTOVER HILLS - WESTOVER RD FROM INTERSECTION WITH HOPETON RD TO INTERSECTION W/ EDGEHILL RD @1100 WESTOVER RD**

LENGTH 173.7360 m 570.0000 L.F.

GENERAL IMPROVEMENTS

2" MILL AND OVERLAY(CURB WHERE NECESSARY)

COMMENTS:

MATERIAL ESTIMATE FOR LOCATION 28

211001	REMOVAL OF PORTLAND CEMENT CONCRETE PAVEMENT, CURB AND SIDEWALK	432.00	S.Y.
301002	GRADED AGGREGATE BASE COURSE, TYPE B, PATCHING	81.00	C.Y.
401005	SUPERPAVE TYPE C, PG 64-22 (CARBONATE STONE)	230.00	TON
401029	SUPERPAVE TYPE C, PG 64-22, PATCHING	280.00	TON
402000	BITUMINOUS CONCRETE PATCHING	4,200.00	SY-IN
602132	ADJUSTING AND REPAIRING EXISTING MANHOLE	1.00	EACH
701019	INTEGRAL PORTLAND CEMENT CONCRETE CURB AND GUTTER, TYPE 2	1,400.00	L.F.
705001	PORTLAND CEMENT CONCRETE SIDEWALK, 4"	560.00	S.F.
705002	PORTLAND CEMENT CONCRETE SIDEWALK, 6"	1,120.00	S.F.
705007	SIDEWALK SURFACE DETECTABLE WARNING SYSTEM	60.00	S.F.
705008	PEDESTRIAN CONNECTION, TYPE 1	400.00	S.F.
705009	PEDESTRIAN CONNECTION, TYPE 2, 3, AND/OR 4	800.00	S.F.
760010	PAVEMENT MILLING, BITUMINOUS CONCRETE PAVEMENT	3,680.00	SY-IN
762000	SAW CUTTING, BITUMINOUS CONCRETE	2,100.00	L.F.
762001	SAW CUTTING, CONCRETE, FULL DEPTH	210.00	L.F.
811001	FLAGGER, NEW CASTLE COUNTY STATE	496.00	HOUR
811013	FLAGGER, NEW CASTLE COUNTY, STATE, OVERTIME	50.00	HOUR
908001	TOPSOIL	158.00	TON
908016	PERMANENT GRASS SEEDING, SUBDIVISION	948.00	S.Y.
908020	EROSION CONTROL BLANKET MULCH	948.00	S.Y.

DELAWARE DEPARTMENT OF TRANSPORTATION

CONTRACT T201903105.01

(CAD) PAGE 54 OF 56

CANAL

COMMUNITY TRANSPORTATION FUND, NORTH V, 2019

LOCATION 29 WESTSIDE HUNT - WESTSIDE LANE FROM CUL-DE-SAC ONLY

LENGTH 6.7056 m 22.0000 L.F.

GENERAL IMPROVEMENTS

2" MILL AND OVERLAY(CURB WHERE NECESSARY)

COMMENTS:

ESTIMATE FOR CUL-DE-SAC AT THE END OF WESTSIDE LANE

MATERIAL ESTIMATE FOR LOCATION 29

401005	SUPERPAVE TYPE C, PG 64-22 (CARBONATE STONE)	95.00	TON
401030	SUPERPAVE TYPE B, PG 64-22, PATCHING	12.00	TON
402000	BITUMINOUS CONCRETE PATCHING	208.00	SY-IN
760010	PAVEMENT MILLING, BITUMINOUS CONCRETE PAVEMENT	1,520.00	SY-IN
762000	SAW CUTTING, BITUMINOUS CONCRETE	185.00	L.F.
811001	FLAGGER, NEW CASTLE COUNTY STATE	64.00	HOUR
811013	FLAGGER, NEW CASTLE COUNTY, STATE, OVERTIME	6.00	HOUR

DELAWARE DEPARTMENT OF TRANSPORTATION

CONTRACT T201903105.01

(CAD) PAGE 55 OF 56

CANAL

COMMUNITY TRANSPORTATION FUND, NORTH V, 2019

CONTRACT QUANTITIES SUMMARY SHEET

201000	CLEARING AND GRUBBING	1.00	L.S.
202000	EXCAVATION AND EMBANKMENT	140.00	C.Y.
209004	BORROW, TYPE C	20.00	C.Y.
211001	REMOVAL OF PORTLAND CEMENT CONCRETE PAVEMENT, CURB AND SIDEWALK	2,243.00	S.Y.
211501	TREE REMOVAL, GREATER THAN 15" TO 25" DIAMETER	2.00	EACH
301001	GRADED AGGREGATE BASE COURSE, TYPE B	18.00	C.Y.
301002	GRADED AGGREGATE BASE COURSE, TYPE B, PATCHING	432.00	C.Y.
401005	SUPERPAVE TYPE C, PG 64-22 (CARBONATE STONE)	5,030.00	TON
401029	SUPERPAVE TYPE C, PG 64-22, PATCHING	1,458.00	TON
401030	SUPERPAVE TYPE B, PG 64-22, PATCHING	156.00	TON
401506	SPEED HUMP	544.00	L.F.
402000	BITUMINOUS CONCRETE PATCHING	22,804.00	SY-IN
501001	PORTLAND CEMENT CONCRETE PAVEMENT, 8"	50.00	S.Y.
504001	CRACK AND JOINT SEALING LESS THAN 3/4 INCH WIDE	1,124.00	L.F.
602100	REPLACE DRAINAGE INLET GRATE(S)	11.00	EACH
602101	REPLACE DRAINAGE INLET FRAME(S)	11.00	EACH
602130	ADJUSTING AND REPAIRING EXISTING DRAINAGE INLET	18.00	EACH
602131	ADJUSTING AND REPAIRING EXISTING DOUBLE DRAINAGE INLET	5.00	EACH
602132	ADJUSTING AND REPAIRING EXISTING MANHOLE	45.00	EACH
701013	PORTLAND CEMENT CONCRETE CURB, TYPE 1-8	20.00	L.F.
701018	INTEGRAL PORTLAND CEMENT CONCRETE CURB AND GUTTER, TYPE 1-8	20.00	L.F.
701019	INTEGRAL PORTLAND CEMENT CONCRETE CURB AND GUTTER, TYPE 2	6,600.00	L.F.
701023	INTEGRAL PORTLAND CEMENT CONCRETE CURB AND GUTTER, TYPE 3-8	230.00	L.F.
701031	CURB OPENING, 2' OPENING	2.00	EACH
705001	PORTLAND CEMENT CONCRETE SIDEWALK, 4"	2,749.00	S.F.
705002	PORTLAND CEMENT CONCRETE SIDEWALK, 6"	5,578.00	S.F.
705007	SIDEWALK SURFACE DETECTABLE WARNING SYSTEM	140.00	S.F.
705008	PEDESTRIAN CONNECTION, TYPE 1	400.00	S.F.

DELAWARE DEPARTMENT OF TRANSPORTATION

CONTRACT T201903105.01

(CAD) PAGE 56 OF 56

CANAL

COMMUNITY TRANSPORTATION FUND, NORTH V, 2019

CONTRACT QUANTITIES SUMMARY SHEET

705009	PEDESTRIAN CONNECTION, TYPE 2, 3, AND/OR 4	2,400.00	S.F.
707001	RIPRAP, R-4	25.00	S.Y.
710002	ADJUST WATER VALVE BOXES	2.00	EACH
710370	STEEL CASING PIPE, 4"	60.00	L.F.
760010	PAVEMENT MILLING, BITUMINOUS CONCRETE PAVEMENT	78,070.00	SY-IN
760011	PAVEMENT MILLING, BITUMINOUS CONCRETE PAVEMENT, TAPER CUT	1,925.00	SY-IN
762000	SAW CUTTING, BITUMINOUS CONCRETE	10,770.00	L.F.
762001	SAW CUTTING, CONCRETE, FULL DEPTH	1,055.00	L.F.
762004	BUTT JOINTS	100.00	S.Y.
763000	INITIAL EXPENSE/DE-MOBILIZATION	LUMP	SUM
763501	CONSTRUCTION ENGINEERING	1.00	L.S.
801500	MAINTENANCE OF TRAFFIC, ALL INCLUSIVE	LUMP	SUM
802003	ARROW PANELS TYPE C	18.00	EA-DY
808001	FURNISH AND MAINTAIN TRUCK MOUNTED ATTENUATOR, TYPE I	18.00	EA-DY
811001	FLAGGER, NEW CASTLE COUNTY STATE	3,840.00	HOUR
811013	FLAGGER, NEW CASTLE COUNTY, STATE, OVERTIME	386.00	HOUR
817002	PERMANENT PAVEMENT STRIPING, SYMBOL/LEGEND, ALKYD-THERMOPLASTIC	426.00	S.F.
817003	TEMPORARY MARKINGS, PAINT, 4"	24.00	L.F.
817013	PERMANENT PAVEMENT STRIPING, EPOXY RESIN PAINT, WHITE/YELLOW, 5"	24.00	L.F.
905004	INLET SEDIMENT CONTROL, DRAINAGE INLET	8.00	EACH
908001	TOPSOIL	512.00	TON
908016	PERMANENT GRASS SEEDING, SUBDIVISION	3,130.00	S.Y.
908020	EROSION CONTROL BLANKET MULCH	3,130.00	S.Y.